

GENERAL CATALOG

OMNI[●]**PRO**
● AUTOMATISMOS

OMNIPRO
AUTOMATISMOS

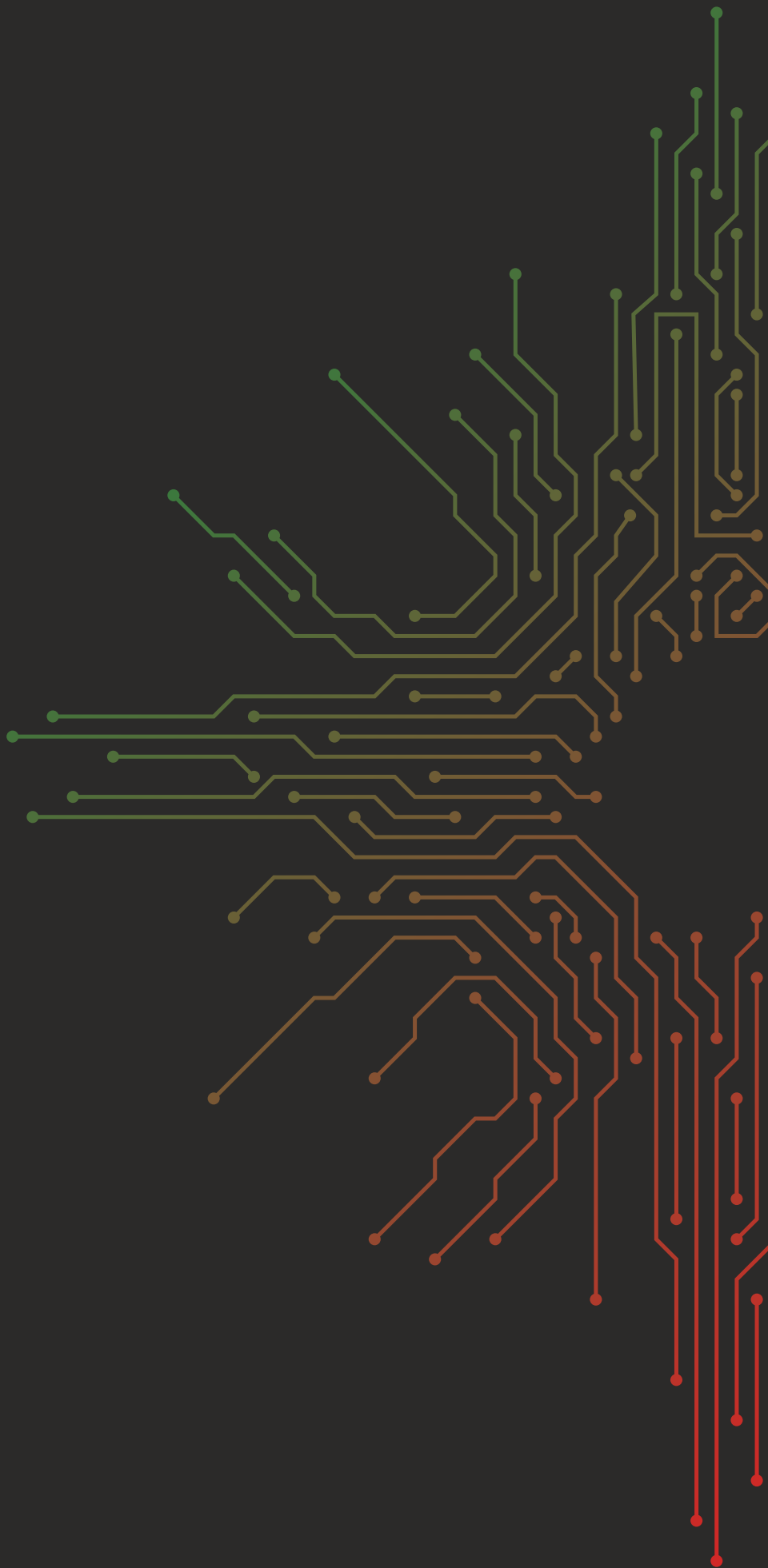

GENERAL CATALOG



Index

Sliding Gates Motors	05 - 13
Swing Gates Motors	15 - 29
Garage Doors Motors	29 - 33
Industrial Motors	35 - 37
Rolling Shutter Motors	39 - 43
Glass Door	45 - 50
Barriers	51 - 54
Bollards	55 - 56
Access Control	57 - 61
Solar Panels	63 - 64
Accessories	65 - 75
Windows Motors	77 - 78
High Speed Doors	79 - 81
Loading Dock	83 - 84
Eletronicos	85 - 95

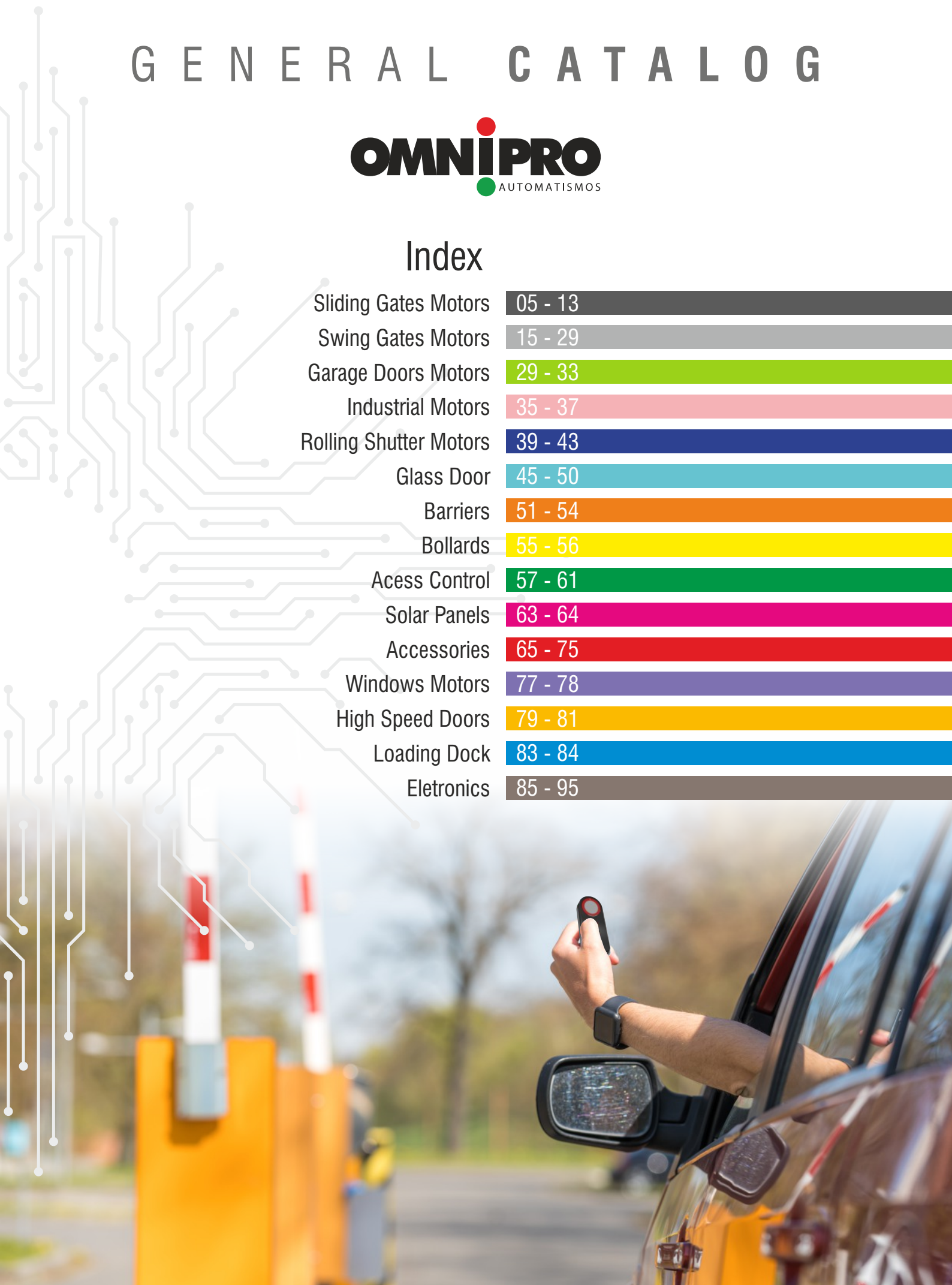

OMNIPRO is a leading Portuguese company in the field of residential and industrial automation, which offers a high quality and which, combined with a global experience, allows us to respond to the different individual challenges of each specificity, combined with professional experience, dynamism and professionalism at the service of its customers.

Global Company

- Sharing knowledge, experience and innovation.

Local teams

- Local Skills
- Customer proximity

Strong presence and technical/commercial capacity

Alliances with local distributors and industrial partners

Automation Solutions

OMNIPRO has a unique and comprehensive portfolio of products, systems and services, developed to measure, using the most innovative technologies and covering all market segments:

Residential/commercial automations

- Garage door, Sliding door, Swing door, Automatic glass door

Barriers and access control

- Barriers, Bollards and Access Control

Industrial automation

- Sectional industrial doors
- High Speed PVC doors
- Rolling Grilles



May 2005 marked the end of the transition period for adaptation to European standards in CE Certification for Doors and Automation

- The sale and installation of doors and automations without CE marking is prohibited
- The installer is responsible for all direct and indirect damages caused by the automation and may be subject to fines of up to 44890EUR (Decree-Law n.º 23/2011)

For CE marking, the product must comply with:

- Product Directive 89/106/EC
- Electromagnetic Compatibility Directive 2004/108/EC
- Machinery Directive 2006/42/CE
- Low Voltage Directive 2006/95/CE
- RoHS Directive 2001/65/EU

Safety rules

EN12453 e EN12445

EN ISO 13849-1

EN 60335-1

EN 61000-6-3

EN 61000-6-2

EN 60335-2-95

EN 60335-2-103



Check if your Automatism complies with the new EN12453 and EN12445 standards:

- Sliding Gates: Maximum Impact Force 1400N
- Garage Doors : Maximum Impact Force 400N

After 0.75 seconds the automation must not exert a force greater than 150N, after 5 seconds this force must be zero.





Sliding Gates Motors



Sliding Gates Motors

SPRINT 600-21 | 800-21

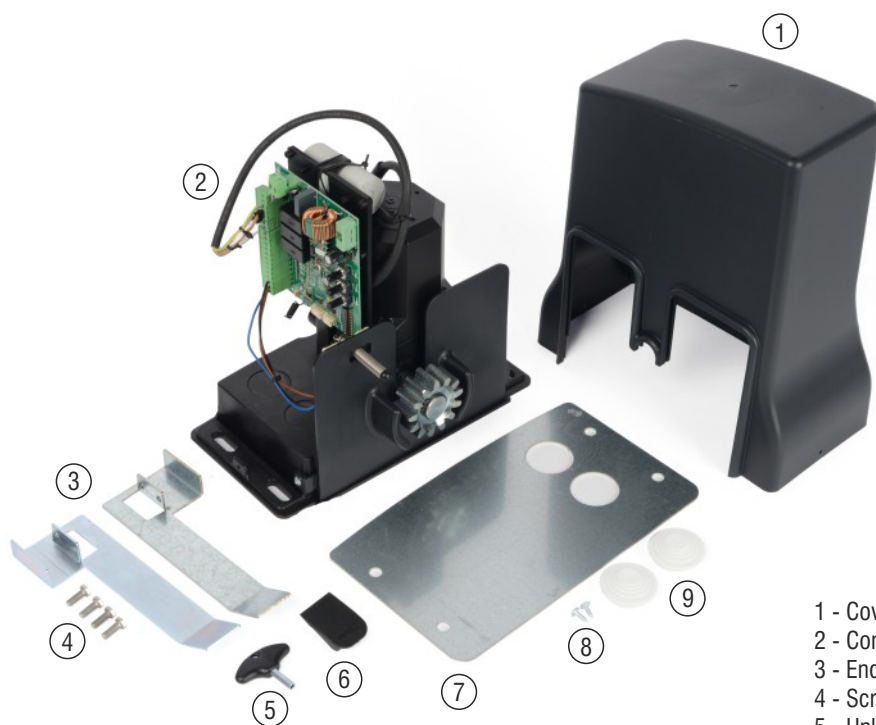

- 1 - Cover
- 2 - Control board with receiver (PL020)
- 3 - End-of-stroke fixing plates
- 4 - Screws for fixing the limit switch plate
- 5 - Unlock key
- 6 - Front unlocker cover
- 7 - Fixing plate
- 8 - Cover fixing screws
- 9 - Cover fixing screws

Motor for industrial / residential doors

of 600Kg and 800Kg.

- Able to move doors up to 15 meters extremely quickly and safely
- High breakaway torque to break inertia
- Intensive use up to 250 operations per day
- Electromechanical end-of-stroke control technology

Easy installation and configuration

- Reduced dimensions for easier installation
- Simplified operability setup

Configurable speed

- Maximum speed of 0.17m/sec
- Adjusting the force level on opening and closing slowdown

Adjustable torque control

- No crush detection

Automatic Fermeture

- Adjustable closing time up to 2 minutes

Pedestrian mode

- 50% opening of the entire gate

Power supply

- Additional protections against mains variations and overloads

Emergency Unlock

- It has an unlocking system with a key for manual opening

Condominium Mode Option

- Automatism does not stop the opening movement with the emitter

Closure photocells

- Ensures security in closing operations
- The installation of a photocell kit is essential in this automatism

Built-in radio frequency receiver

- Secure encoding based on Rolling Code Keeloq 433.92MHz encryption
- Receiver memory up to 200 transmitters

Safety certifications and standards

- CE marked and in accordance with European standards EN12445 /EN12453

230
volts

CE

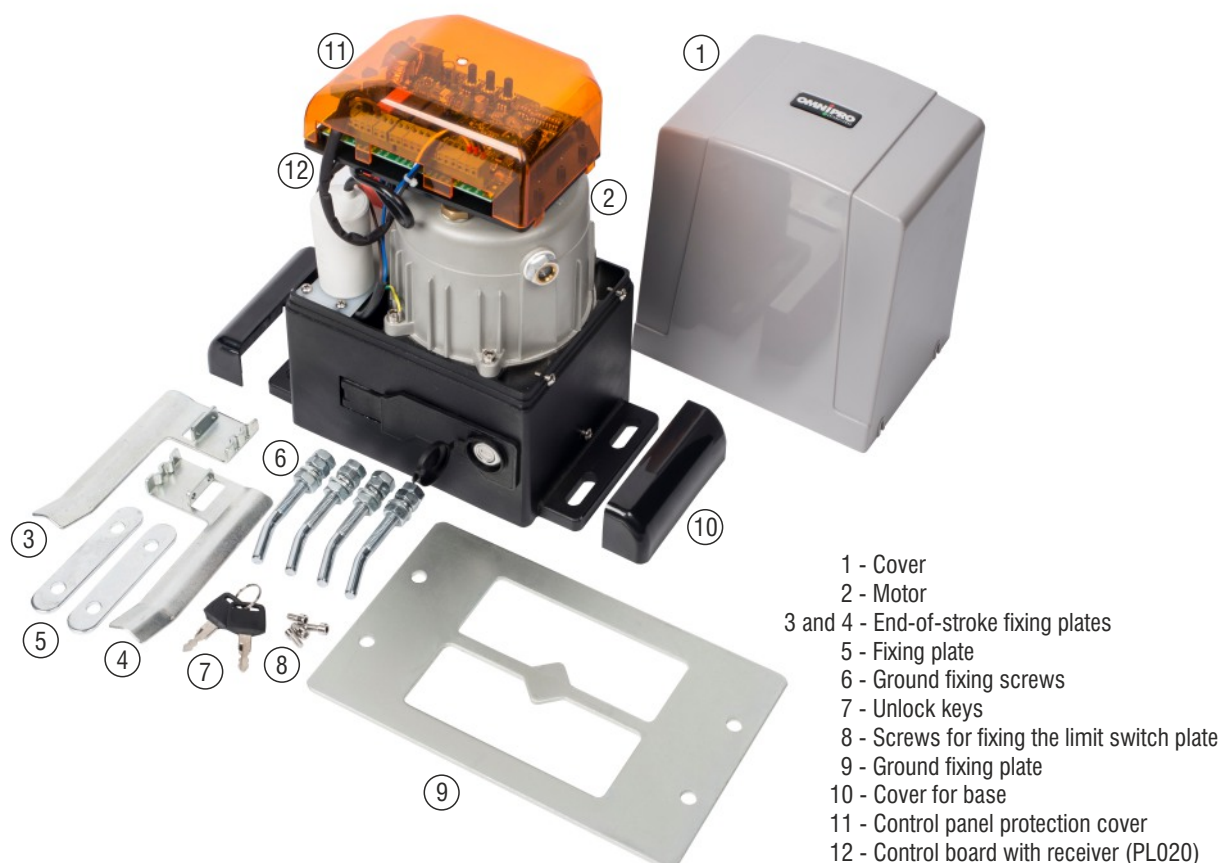

Motor for industrial / residential doors

of 600Kg, 1000Kg, 1500kg and 2000Kg.

- Able to move doors up to 15 meters extremely quickly and safely
- High breakaway torque to break inertia
- Intensive use up to 250 operations per day
- Electromechanical end-of-stroke control technology

Easy installation and configuration

- Reduced dimensions for easier installation
- Simplified operability setup

Configurable speed

- Maximum speed of 0.16m/sec
- Adjusting the force level on opening and closing slowdown

Adjustable torque control

- No crush detection

Automatic Fermeture

- Adjustable closing time up to 2 minutes

Pedestrian mode

- 50% opening of the entire gate

Power supply

- Additional protections against mains variations and overloads

Emergency Unlock

- It has an unlocking system with a key for manual opening

Condominium Mode Option

- Automatism does not stop the opening movement with the emitter

Closure photocells

- Ensures security in closing operations
- The installation of a photocell kit is essential in this automatism

Built-in radio frequency receiver

- Secure encoding based on Rolling Code KeeLoq 433.92MHz encryption
- Receiver memory up to 200 transmitters

Safety certifications and standards

- CE marked and in accordance with European standards EN12445 /EN12453

230
volts

CE

Sliding Gates Motors

SPRINT 300

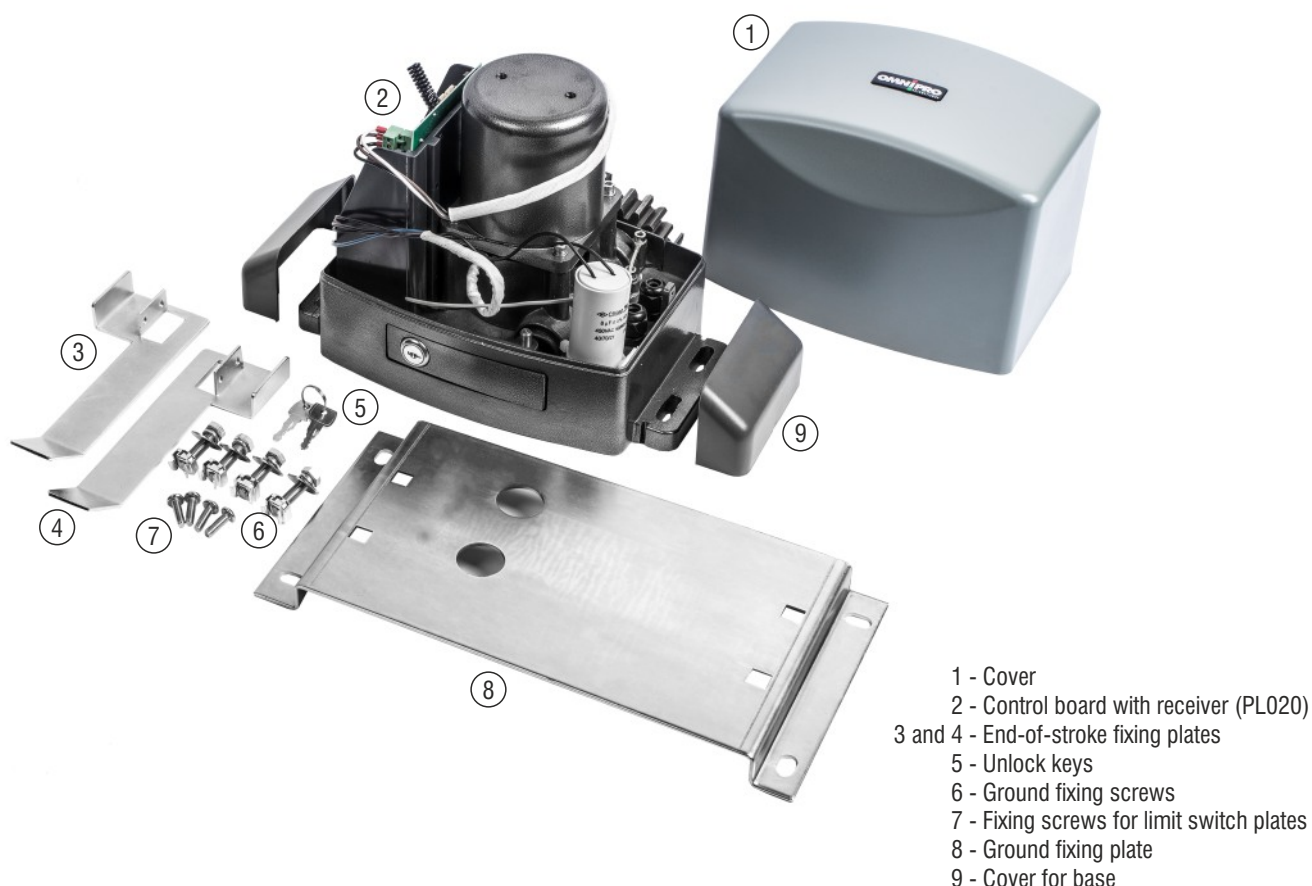

- 1 - Cover
- 2 - Control board with receiver (PL020)
- 3 and 4 - End-of-stroke fixing plates
- 5 - Unlock keys
- 6 - Ground fixing screws
- 7 - Fixing screws for limit switch plates
- 8 - Ground fixing plate
- 9 - Cover for base

300Kg Residential Door Motor

- Able to move doors up to 15 meters extremely quickly and safely
- High breakaway torque to break inertia
- Intensive use up to 250 operations per day
- Electromechanical end-of-stroke control technology

Easy installation and configuration

- Reduced dimensions for easier installation
- Simplified operability setup

Configurable speed

- Maximum speed of 0.16m/sec
- Adjusting the force level on opening and closing slowdown

Adjustable torque control

- No crush detection

Automatic Fermeture

- Adjustable closing time up to 2 minutes

Pedestrian mode

- 50% opening of the entire gate

Power supply

- Additional protections against mains variations and overloads

Emergency Unlock

- It has an unlocking system with a key for manual opening

Condominium Mode Option

- Automatism does not stop the opening movement with the emitter

Closure photocells

- Ensures security in closing operations
- The installation of a photocell kit is essential in this automatism

Built-in radio frequency receiver

- Secure encoding based on Rolling Code Keeloq 433.92MHz encryption
- Receiver memory up to 200 transmitters

Safety certifications and standards

- CE marked and in accordance with European standards EN12445 /EN12453

230
volts

CE



- 1 - Motor
- 2 - Ground fixing screws
- 3 - Unlock keys
- 4 - Base cover fixing screws
- 5 - End of course plate fixing screws
- 6 - Cover opening key
- 7 - End of course opening
- 8 - End of course closing

6000Kg Industrial Motor

- Able to move doors up to 15/20 meters extremely quickly and safely
- High breakaway torque to break inertia
- 25% work frequency
- Electromechanical end-of-course control technology

Easy installation and configuration

- Reduced dimensions for easier installation
- Simplified operability setup

Configurable speed

- Maximum speed of 0.15m/sec
- Adjusting the force level on opening and closing slowdown

Adjustable torque control

- No crush detection

Automatic Fermeture

- Adjustable closing time up to 2 minutes

Pedestrian mode

- 50% opening of the entire gate

Power supply

- Additional protections against mains variations and overloads

Emergency Unlock

- It has an unlocking system with a key for manual opening

Condominium Mode Option

- Automatism does not stop the opening movement with the emitter

Closure photocells

- Ensures security in closing operations
- The installation of a photocell kit is essential in this automatism

Built-in radio frequency receiver

- Secure encoding based on Rolling Code KeeLoq 433.92MHz encryption
- Receiver memory up to 200 transmitters

Safety certifications and standards

- CE marked and in accordance with European standards



Sliding Gates Motors

SPRINT Sliding Gates Motors

SPRINT Sliding Gates Motors Kit

- 1 Control board with built-in receiver;
- 2 4-channel Rolling Code transmitters;
- 1 pair of photocells;
- Connection and fastening accessories;
- Rack not included.



PL020 - OMNIPRO power board for 230V AC Sliding Gate Motors

Dimensions

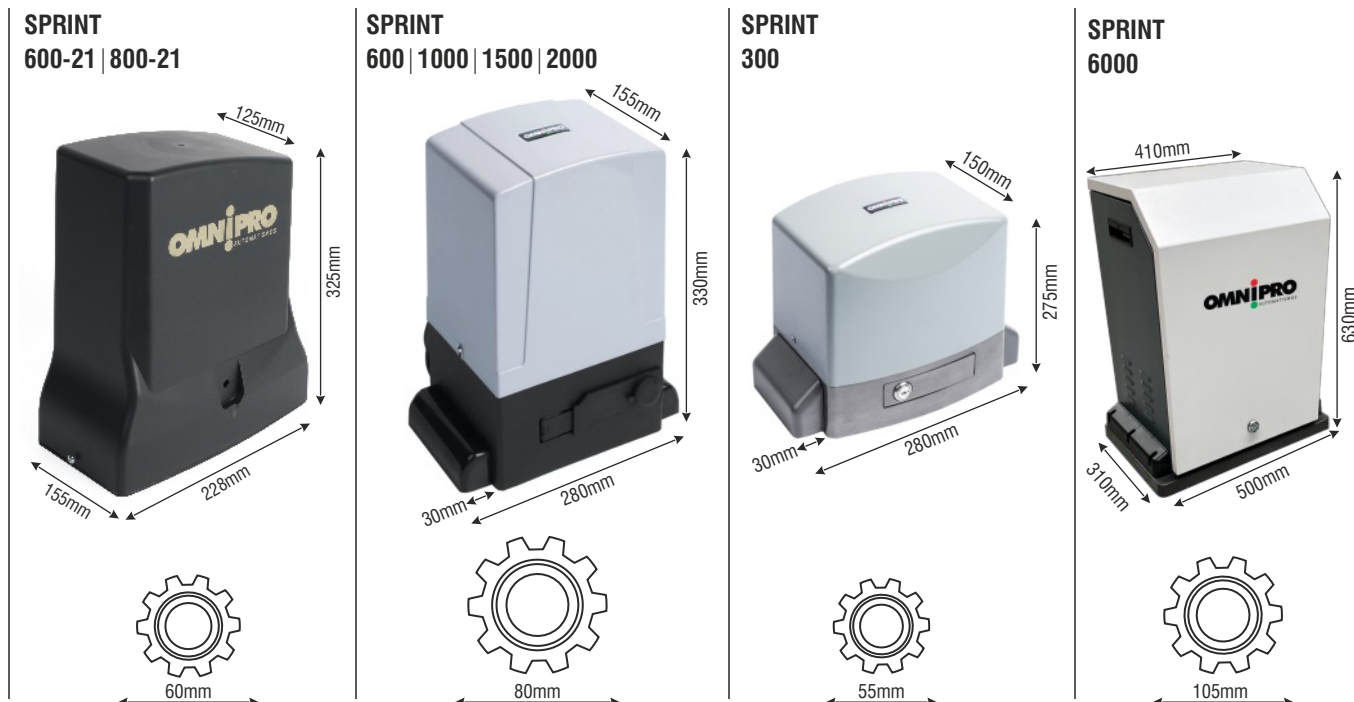

Technical Characteristics

Designation	SPRINT 300 MC014	SPRINT 600 MC010	SPRINT 1000 MC004	SPRINT 1500 MC005	SPRINT 2000 MC006	SPRINT 600-21 MC018	SPRINT 800-21 MC020	SPRINT 6000 MC022
Motor power supply	230Vac / 50Hz							380Vac / 50Hz
Motor power	200W	300W	500W	750W	1000W	190W	350W	2200W
Supply for accessories	12Vdc							
Receiver Frequency	433,92MHz Rolling Code							
Receiver Memory	Até 200 remote control							
Torque	12Nm	18Nm	27Nm	38Nm	45Nm	13,4Nm	21,2Nm	280Nm
Speed	0,16m/s					0,17m/s		0,15m/s
Maximum weight	300Kg	600Kg	1000Kg	1500Kg	2000Kg	600Kg	800Kg	6000Kg
Room temperature	-45°C a +65°C					-20°C a +60°C		-45°C a +65°C
Noise	≤ 56dB							≤ 65dB
End of course	Electromechanical							
Protection Index	IP44							
Thermal protection	150°C							130°C
Racks (1000mm)	Nylon (28x20) or Steel (30x10)			Steel (30X10)		Nylon (28x20) or Steel (30x10)		Steel (30x30)
Electric latch (contact)	Maximum current 3A (12-24 Vac/Vdc)							Inverter 380V
Command Board	PL020							

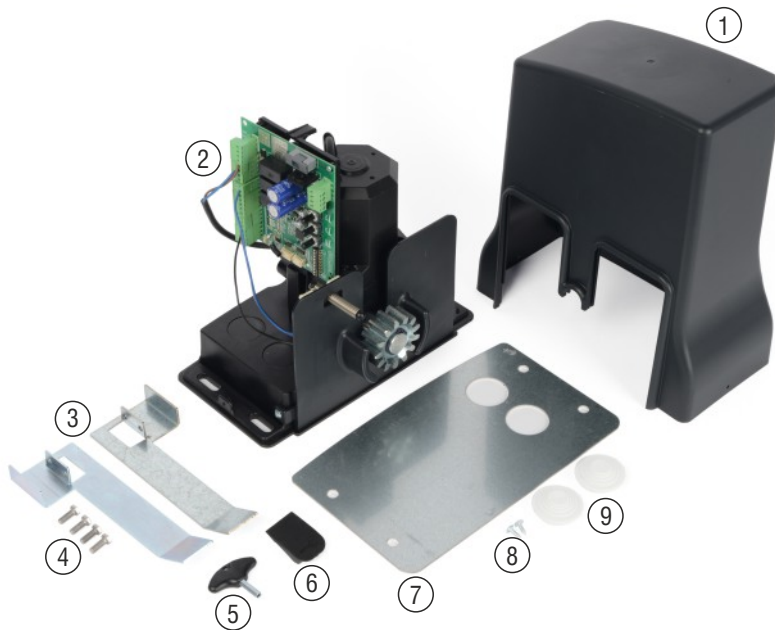

- 1 - Cover
- 2 - Control board with receiver (PL024)
- 3 - End-of-stroke fixing plates
- 4 - Screws for fixing the limit switch plate
- 5 - Unlock key
- 6 - Front unlocker cover
- 7 - Ground fixing plate
- 8 - Cover fixing screws
- 9 - Seals for wiring

Motor for residential gates up to 600kg and 800kg

- Able to move doors up to 15 meters extremely quickly and safely
- High breakaway torque to break door inertia
- Electromechanical end-of-stroke control technology

Easy installation and configuration

- Reduced dimensions for easier installation
- Simplified operability setup

Adaptive anti-crush

- Adjusting the force needed to open and close securely
- Obstacle detection and crush prevention

Configurable speed

- Maximum speed of 0.17m/sec
- Slowdown in opening and closing

Automatic closing

- Adjustable closing time up to 2 minutes

Pedestrian mode

- 50% opening of the entire gate

Closure photocells

- Ensures security in closing operations

Built-in radio frequency receiver

- Secure encoding based on Rolling Code Keeloq 433.92MHz encryption
- Receiver memory up to 200 transmitters

Dual power supply

- Additional protections against mains variations and overloads
- 2 x Optional 12V, 7Ah batteries with capacity up to 40 closing and opening operations

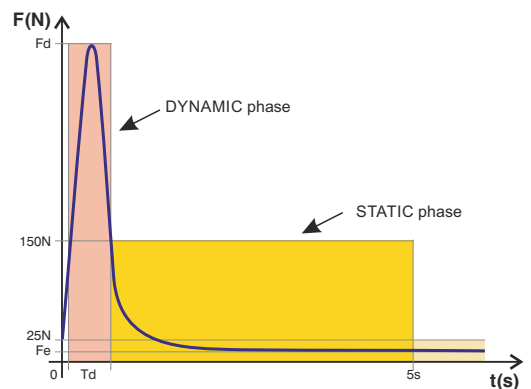

Safety certifications and standards

- CE marked and in accordance with European standards EN12445 /EN12453

Emergency Unlock

- It has an unlocking system with a key for manual opening

Condominium Mode Option

- Automatism does not stop the opening movement with the emitter

LED flashlight control

- 24Vdc output power with 3 seconds notice

24
volts

EN
12445
12453
CONFORME

CE

FOX Sliding Gates Motors Kit

- 1 Control board with receiver;
- 2 4-channel Rolling Code transmitters;
- 1 pair of photocells;
- Connection and fastening accessories;
- Rack not included.

Technical Characteristics

Designation	FOX 600-21 MC001	FOX 800-21 MC002
Engine power	24Vdc - 50Hz	
Motor power	70W	120W
Accessory supply	12Vdc - max. 500mA	
Absorbed current	4A	6A
Receiver frequency	433,92 MHz, Rolling Code	
Receiver memory	Up to 200 issuers	
Motor Rotations	1400 RPM	
Speed	0,18m/s	
Maximum gate weight	600 Kg	800 Kg
Room temperature	From -20°C to +60°C	
Noise	≤ 56 dB	
End of course	Electromechanical	
Protection index	IP44	
Work frequency	Intensive	
Backup Battery	2x12V for emergency operation in case of power failure (Optional)	
Electric latch (contact)	3A Max. Current (12-24 Vac/Vdc)	
Racks	Nylon(30x10mm) or Steel(12x18mm)	
Switchboard	PL024	

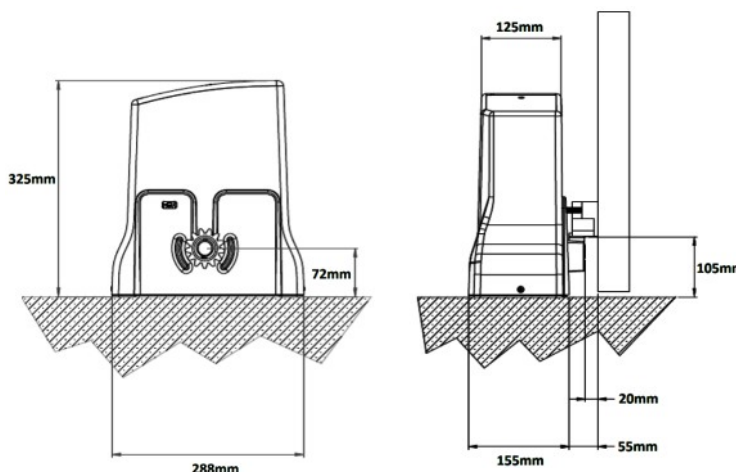

PL024
OMNIPRO power board
for Sliding Gate Motors
Running 24V DC

Racks



CR001 - Reinforced Nylon Rack with 6 Fix. - 1m (28x20mm)



CR002 - Steel Rack - 1m (30x10mm)

AC036 Speed Regulating Damper

Description

This accessory is designed to regulate and control the speed of the door or gate in installations when the door or gate is not mounted vertically and the opening or closing must be controlled against gravity for safety reasons.

The damper provides resistance only in one direction of rotation, the opposite direction has free movement.

This accessory can be used on automatic doors or gates with a module 4 rack. It is made of anti-corrosive materials, intended to be used outdoors.



Dimensions

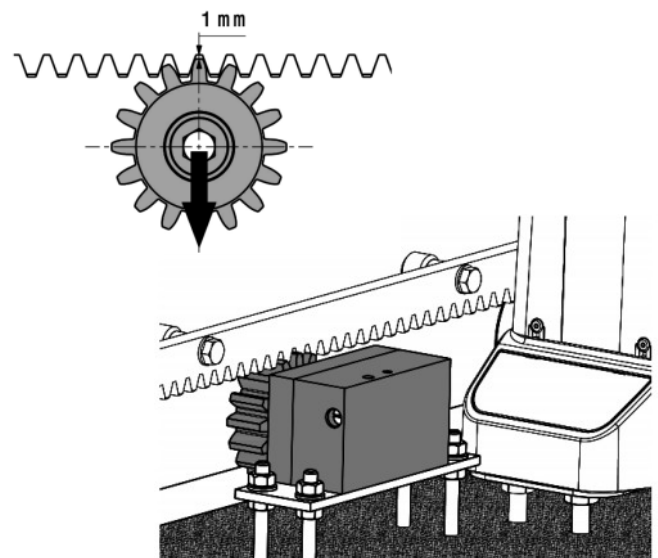
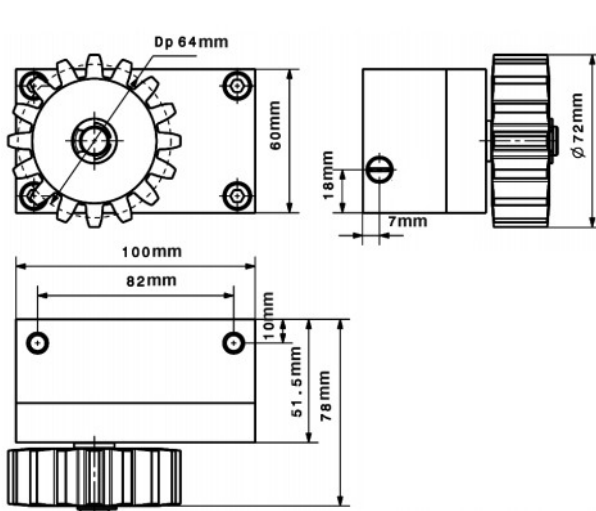

Regulating Damper Calculation

$$M [Nm] = P \times \sin\beta \times 0,032$$

P = Door weight in Newtons ($9,8N = 1Kg$)

β = Inclination in degrees

$M \leq 7Nm$ = Must guarantee this condition

Technical Characteristics

Number of Teeth	Z16
Type of Liquid	Silicone 3000
Ambiance temperature	From -15°C to + 70°C
Maximum weight	7 Nm / 4000kg
Adjustable Brake Steering	Left/Right
Load Adjustment	Yes

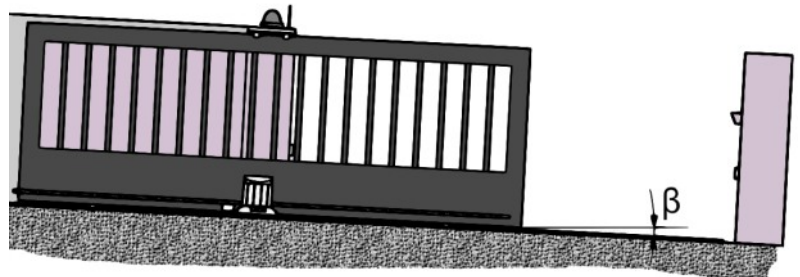



Swing Gates Motors



Swing Gates Motors

GR400 | GR600

GR400

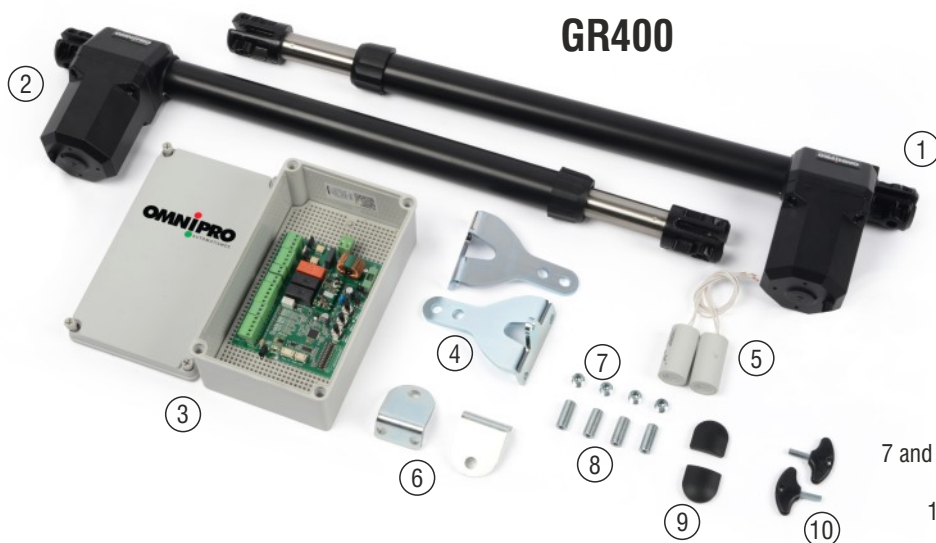

- 1 - Right Motor GR400 (MB003)
- 2 - Left Motor GR400 (MB004)
- 3 - Control board with receiver for two arms (PL023)
- 4 - Rear supports
- 5 - Condensers (8 μ F)
- 6 - Front supports
- 7 and 8 - Motor fixing accessories
- 9 - Cover for unlocker
- 10 - Unlock keys

GR600

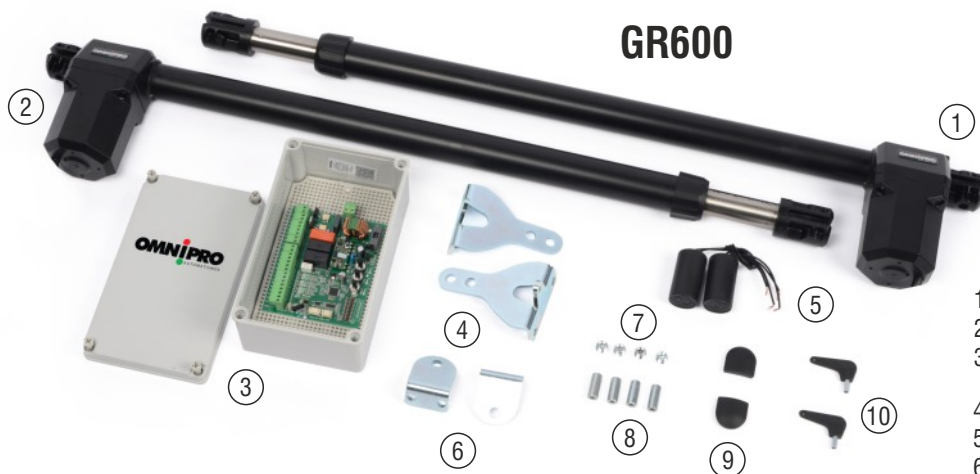

- 1 - Right Motor GR600 (MB016)
- 2 - Left Motor GR600 (MB017)
- 3 - Control board with receiver for two arms (PL023)
- 4 - Rear supports
- 5 - Condensers (8 μ F)
- 6 - Front supports
- 7 and 8 - Motor fixing accessories
- 9 - Cover for unlocker
- 10 - Unlock keys

Arm motors for 2 sheets up to 5m and 250kg/sheet

- Slowdown in opening and closing
- Independent adjustment of working time on both engines and lag between engines

Safety mode

- Ensures activation of electric lock on closing no fecho

Course

- Models with 400mm and 600mm stroke

LED flashlight control

- 230Vac output power with 3 seconds pre-warning

Built-in radio frequency receiver

- Secure encoding based on Rolling Code Keeloq 433.92MHz encryption (200 users)

Closure photocells

- Ensures security in closing operations
- The installation of a photocell kit is essential in this automatism

Pedestrian mode

- 2 Motors only opens motor 1;
- 1 Engine only opens at 50% of course

230
volts

CE

Gr400 Swing Gate Motors | GR600

GR Swing Gate Motors Kit

- 1 Control board with receiver for two arms (PL023);
- 2 Swing Gate Motor;
- 1 watertight outer wall box;
- 2 4-channel Rolling Code transmitters;
- 1 pair of photocells;
- Connection and fastening accessories.

Models

	Article	Description	Installation	Max. length by sheet	Max. weight by sheet
GR400 230 Vac	MB005	Kit GR400 (2 arms)	Irreversible	4m	250Kg
	MB010	Kit GR400 (1 Right Arm)			
	MB015	Kit GR400 (1 Left Arm)			
	MB003	Motor GR400 (1 Right Arm)			
	MB004	Motor GR400 (1 Left Arm)			
GR600 230 Vac	MB018	Kit GR600 (2 arms)	Irreversible	5m	250Kg
	MB019	Kit GR600 (1 Right Arm)			
	MB020	Kit GR600 (1 Left Arm)			
	MB016	Motor GR600 (1 Right Arm)			
	MB017	Motor GR600 (1 Left Arm)			

Dimensions

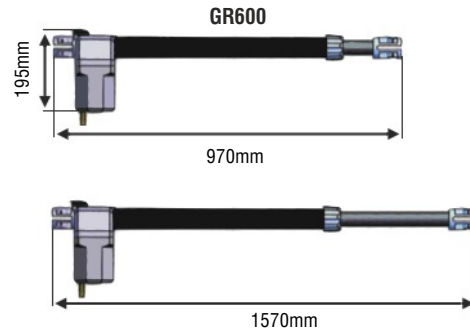
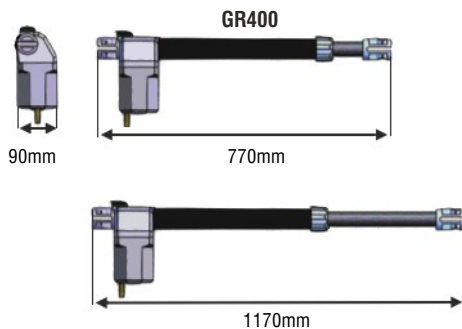

Assembly quotas

MOTOR	95° opening angle				120° opening angle			
	W	X	Y	Z	W	X	Y	Z
GR400	1122	145	145	478	1122	170	110	478
GR600	1532	280	280	678	1532	310	120	678

Measures in mm

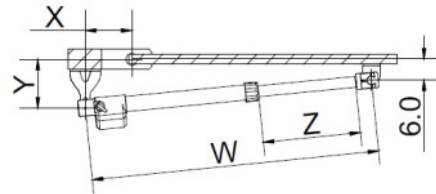

Technical Characteristics

Designation	GR 400 (MB015)	GR 600 (MB018)
Max. length by sheet	4m	5m
Maximum weight per sheet	250Kg	250Kg
Piston stroke	40cm	60cm
Power	180W	180W
Power supply	230V	230V
Amperes	1A	1A
Maximum torque	1600N	1600N
Room temperature	-25°C to +60°C	-25°C to +60°C
Opening time	22s	33s
Thermal protection	150°C	150°C
Work cycle	35%	35%
Lubrication	Solid mass	Solid mass

Charact. Tech. of the Control Board

Designation	Control Board (PL023)
Power supply	230Vac - 50Hz
Maximum power	1000W
Room temperature	-20°C to +70°C
Protection fuse	5A - Slow
Protection index	IP65
Receiver memory	Up to 200 issuers
Electric lock (contact)	12/24 Vdc/Vac 3A maximum current
Box dimensions	H248 x W148 x D132 mm

Control Board (Optional)



PL023FE - OMNIPRO
power board for 2 230Vac
Swing Gate Motors (Prepared
for 12Vdc Electric Lock - 3A)

Swing Gates Motors

GR400II



- 1 - GR400 II Right Motor (MB040)
- 2 - GR400 II Left Motor (MB041)
- 3 - Control board with receiver for two arms (PL023)
- 4 - Rear supports
- 5 - Condensers (8 μ F)
- 7 and 8 - Motor fixing accessories
- 9 - Unlock Keys

Arm motors for 2 sheets up to 3.5m and 300kg/sheet

- Slowdown in opening and closing
- Independent adjustment of working time on both engines and lag between engines

Safety mode

- Ensures activation of electric lock on closing no fecho

Course

- Model with 400mm stroke

LED flashlight control

- 230Vac output power with 3 seconds pre-warning

Built-in radio frequency receiver

- Secure encoding based on Rolling Code
- Keeloq 433.92MHz encryption (200 users)

Closure photocells

- Ensures security in closing operations
- The installation of a photocell kit is essential in this automatism

Pedestrian mode

- 2 Motors only opens motor 1;
- 1 Engine only opens at 50% of course

230
volts

CE

Swing Gates Motors

GR 400 II Swing Gate Motor

GR 400 II Swing Gate Motor Kit

- 1 Control board with receiver for two arms (PL023);
- 2 Swing Gate Motor;
- 1 watertight outer wall box;
- 2 4-channel Rolling Code transmitters;
- 1 pair of photocells;
- Connection and fastening accessories.

Models

	Article	Description	Installation	Max. length by sheet	Max. weight by sheet
GR400 II 230 Vac	MB021	Kit GR400 II (2 arms)	Irreversible	3,5m	300Kg
	MB022	Kit GR400 II (1 Right Arm)			
	MB023	Kit GR400 II (1 Left Arm)			
	MB040	Motor GR400 II (1 Right Arm)			
	MB041	Motor GR400 II (1 Left Arm)			

Dimensions

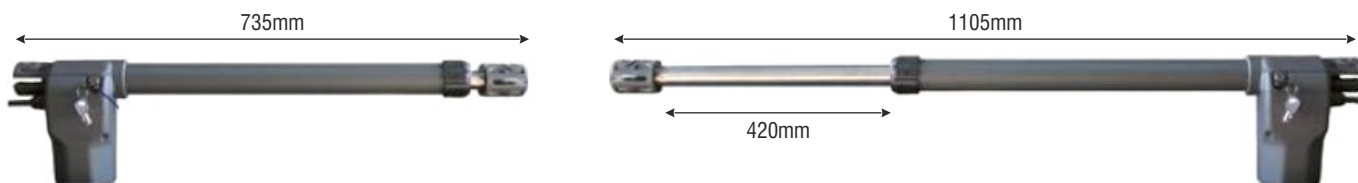

Assembly quotas

Opening angle				
	W	X	Y	Z
90°	1110	150	200	400
90°	1110	200	150	400
95°	1110	200	150	400
100°	1110	200	200	400

Measures in mm

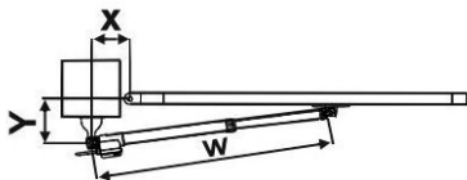

230
volts



Technical Characteristics

Designation	GR 400 II (MB021)
Maximum length per sheet	3,5m
Maximum weight per sheet	300Kg
Power	320W
Power supply	230Vac-50Hz
Amperes	1,5A
Maximum torque	2800N
Room temperature	-20°C to +50°C
Opening time	22s
Thermal protection	150°C
Work cycle	35%
Lubrication	Solid mass

Control Board (Optional)



PL023FE - OMNIPRO
power board for 2 230Vac
Swing Gate Motors (Prepared
for 12Vdc Electric Lock - 3A)

Charact. Tech. of the Control Board

Designation	Control Board (PL023)
Power supply	230 Vac - 50Hz
Maximum power	1000W
Protection fuse	5A - Slow
Receiver memory	200 issuers
Receiver frequency	433.92 ± 3MHz
Protection index	IP65
Electric lock (contact)	12/24 Vdc/Vac 3A maximum current
Box dimensions	A248 x L148 x P132 mm

Swing Gates Motors

SLIM 350



- 1 - SLIM 350 Motors (MB024)
- 2 - Floor stop
- 3 - Back support for pillar
- 4 - Adjustable back support
- 5 - Rear support fixing screws
- 6 - Front support
- 7 - Fixing accessories
- 8 - Unlock keys
- 9 - Screws for securing the waterproof case
- 10 - Floor stop fixing screws
- 11 - Motor fixing bolts
- 12 - Control board with receiver for two arms (PL 025)

Motor for residential doors

- Able to move doors up to 3.5 meters and 350Kg per leaf in an extremely fast and safe way
- High breakaway torque to break gate inertia
- Slowdown in opening and closing

Easy installation and configuration

- Multi-level force adjustment for safe opening and closing, with obstacle detection and crush prevention
- Reduced dimensions for easier installation
- Simplified operability setup

Automatic closing

- Adjustable closing time up to 2 minutes

Pedestrian mode

- 2 Motors just opens Motor 1
- 1 Engine only opens at 50% of course

Dual power supply

- Additional protections against mains variations and overloads
- 2 optional 12V 7A/h batteries with capacity up to 20 operations

Safety certifications and standards

- CE (Europe)

Automatic learning mode

- 1 or 2 motors

Closure photocells

- Ensures security in closing operations

24
volts

EN
12445
12453
CONFORME

CE

Swing Gates Motors

SLIM 350 Swing Gate Motor

SLIM 350 (MB025) Swing Gate Motor Kit

- 1 Control board with receiver for two arms (PL025);
- 2 Swing Gate Motor;
- 1 watertight outer wall box;
- 2 4-channel Rolling Code transmitters;
- 1 pair of photocells;
- Connection and fastening accessories.

Models

	Article	Description	Installation	Max. length by sheet	Max. weight by sheet
SLIM 350 24 Vdc	MB025	Kit SLIM 350 (2 Arms)	Reversible	3,5m	350Kg
	MB026	Kit SLIM 350 (1 Arm)			
	MB024	Motor SLIM 350 (1 Arm)			

Dimensions

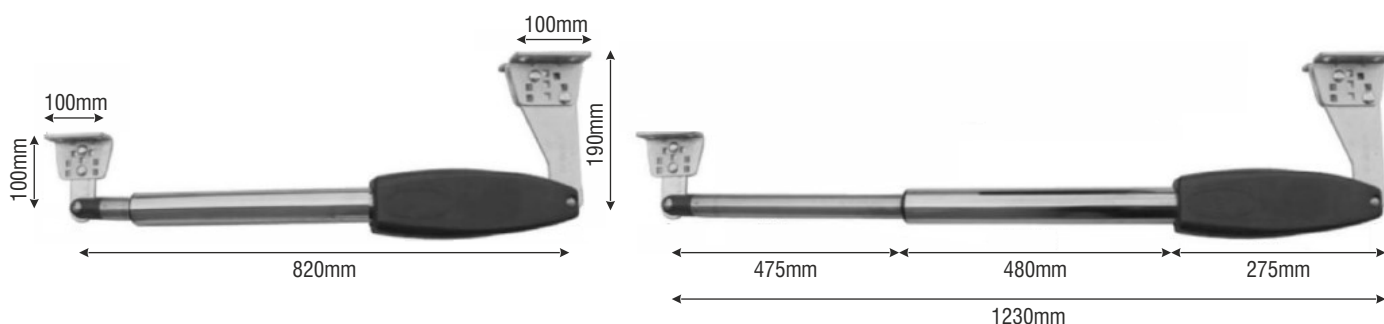

Arm Mounting Dimensions

Opening angle	A (mm)	B (mm)
90°	115	175
110°	95	175

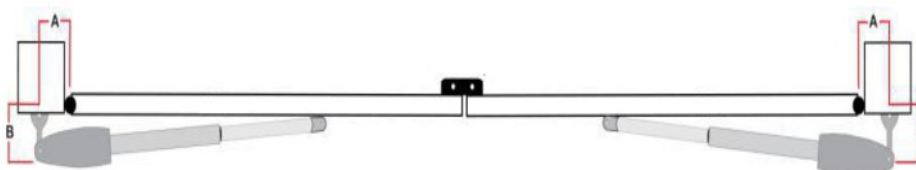

Technical Characteristics

Designation	Swing Gate Motor (MB025)
Motor	24Vdc motor with mechanical unlock
Power	60W
Motor Rotations	300 RPM
Speed	0,24m/s
Maximum Opening Angle	110°
Gear Type	Helical
Impulse	2000N
Maximum Current	4,2A max. of 10s
Maximum Weight per Sheet	350kg
Maximum Length per Sheet	3,5 meters
Temperature	-20°C to +50°C
Weight	7,2 Kg
Protection Index	IP55

Charact. Tech. of the Control Board

Designation	Control Board (PL025)
Power supply	230Vac - 50Hz
Backup Battery	2 x 12V for emergency operation in case of power failure (Optional)
Receiver	Rolling Code, 433.92 MHz, 200 Emitters
Temperature	-20°C to +50°C
Electric lock (contact)	12/24 Vdc/Vac Maximum current 3A
Protection Index	IP65
Box dimensions	H 248 x W148 x D132 mm

Control Board (Optional)



PL025FE - OMNIPRO
power board for 2 24Vdc
Swing Gate Motors (Prepared
for 12Vdc Electric Lock - 3A)

Swing Gates Motors

MASTIM II



Motor for residential doors

- Able to move doors up to 4 meters and 400Kg per leaf in an extremely fast and safe way
- High breakaway torque to break gate inertia
- Slowdown in opening and closing

Easy installation and configuration

- Multi-level force adjustment for safe opening and closing, with obstacle detection and crush prevention
- Reduced dimensions for easier installation
- Simplified operability setup

Automatic closing

- Adjustable closing time up to 2 minutes

Pedestrian mode

- 2 Motors just opens Motor 1
- 1 Engine only opens at 50% of course

Dual power supply

- Additional protections against mains variations and overloads
- 2 optional 12V 7A/h batteries with capacity up to 20 operations

Safety certifications and standards

- CE (Europe)

Automatic learning mode

- 1 or 2 motors

Closure photocells

- Ensures security in closing operations



Quick unlock system



Motor fixing



Bronze transmission gear

24
volts

EN
12445
12453
CONFORME

CE

Swing Gates Motors

MASTIM II Swing Gate Motor

MASTIM II (MB028) Swing Gate Motor Kit

- 1 Control board with receiver for two arms (PL025);
- 2 Swing Gate Motor;
- 1 watertight outer wall box;
- 2 4-channel Rolling Code transmitters;
- 1 pair of photocells;
- Connection and fastening accessories.

Models

	Article	Description	Installation	Max. length by sheet	Max. weight by sheet
MASTIM 400 II 24 Vdc	MB028	Kit MASTIM II (2 Arms)	Reversible	4m	400Kg
	MB029	Kit MASTIM II (1 Arm)			
	MB027	Motor MASTIM II (1 Arm)			

Dimensions

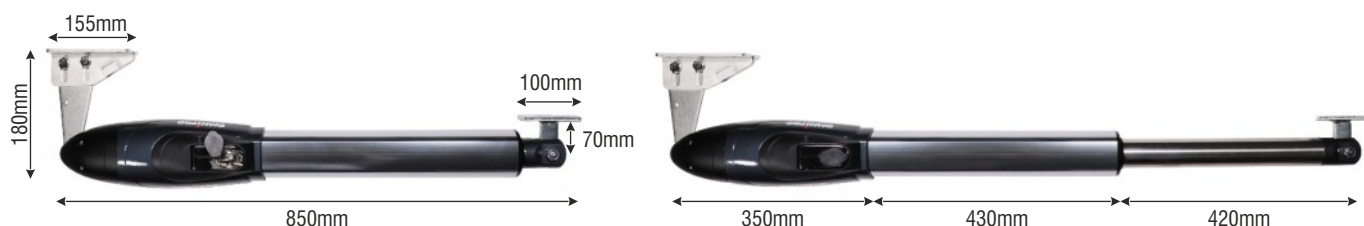

Cotas de montagem dos Braços

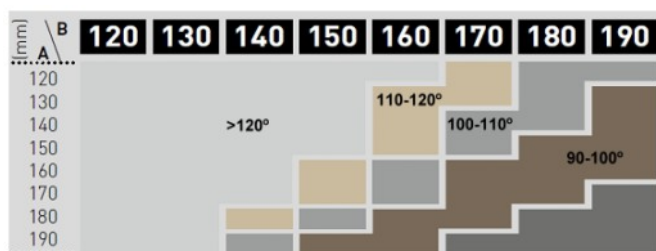

Technical Characteristics

Designation	Swing Gate Motor (MB028)
Motor	24Vdc motor with mechanical unlock
Power	144W
Motor revolutions	250 RPM
Speed	0,24m/s
Maximum Opening Angle	120°
Gear Type	Helical
Impulse	3000N
Maximum Current	5A max. of 10s
Maximum Weight per Sheet	400kg
Maximum Length per Sheet	4 meters
Temperature	-20°C to +50°C
Weight	10 Kg
Protection Index	IP55

Charact. Tech. of the Control Board

Designation	Control Board (PL025)
Power supply	230Vac - 50Hz
Backup Battery	2 x 12V for emergency operation in case of power failure (Optional)
Receiver	Rolling Code, 433.92 MHz, 200 Emitters
Temperature	-20°C to +50°C
Electric lock (contact)	12/24 Vdc/Vac Maximum current 3A
Protection Index	IP65
Box dimensions	H 248 x W148 x D132 mm

Control Board (Optional)



PL025FE - OMNIPRO
power board for 2 24Vdc
Swing Gate Motors (Prepared
for 12Vdc Electric Lock - 3A)

Swing Gates Motors

SPRINGER



- 1 - Articulated engine cover
- 2 - Articulated motor (MB030 Right / MB031 Left)
- 3 - Left articulated arm
- 4 - Right articulated arm
- 5 - Motor fixing plate
- 6 - Support fixing screws
- 7 - Cover fixing screws
- 8 - Unlock keys
- 9 - Control board with receiver for two arms (PL 025)

Motor for residential doors

- Able to move doors up to 2,5 meters and 200Kg per leaf in an extremely fast and safe way
- High breakaway torque to break gate inertia
- Slowdown in opening and closing

Easy installation and configuration

- Multi-level force adjustment for safe opening and closing, with obstacle detection and crush prevention
- Reduced dimensions for easier installation
- Simplified operability setup

Automatic closing

- Adjustable closing time up to 2 minutes

Pedestrian mode

- 2 Motors just opens Motor 1
- 1 Engine only opens at 50% of course

Dual power supply

- Additional protections against mains variations and overloads
- 2 optional 12V 7A/h batteries with capacity up to 20 operations

Safety certifications and standards

- CE (Europe)

Automatic learning mode

- 1 or 2 motors

Closure photocells

- Ensures security in closing operations

24
volts

EN
12445
12453
CONFORME

CE

SPRINGER (MB032) Swing Gate Motor Kit

- 1 Control board with receiver for two arms (PL025);
- 2 Swing Gate Motor;
- 1 watertight outer wall box;
- 2 4-channel Rolling Code transmitters;
- 1 pair of photocells;
- Connection and fastening accessories.

Models

	Article	Description	Installation	Max. length by sheet	Max. weight by sheet
SPRINGER 24 Vdc	MB032	Kit SPRINGER (2 arms)	Irreversible	2,5m	200Kg
	MB033	Kit SPRINGER (1 Right Arm)			
	MB034	Kit SPRINGER (1 Left Arm)			
	MB030	Motor SPRINGER (1 Right Arm)			
	MB031	Motor SPRINGER (1 Left Arm)			

Dimensions

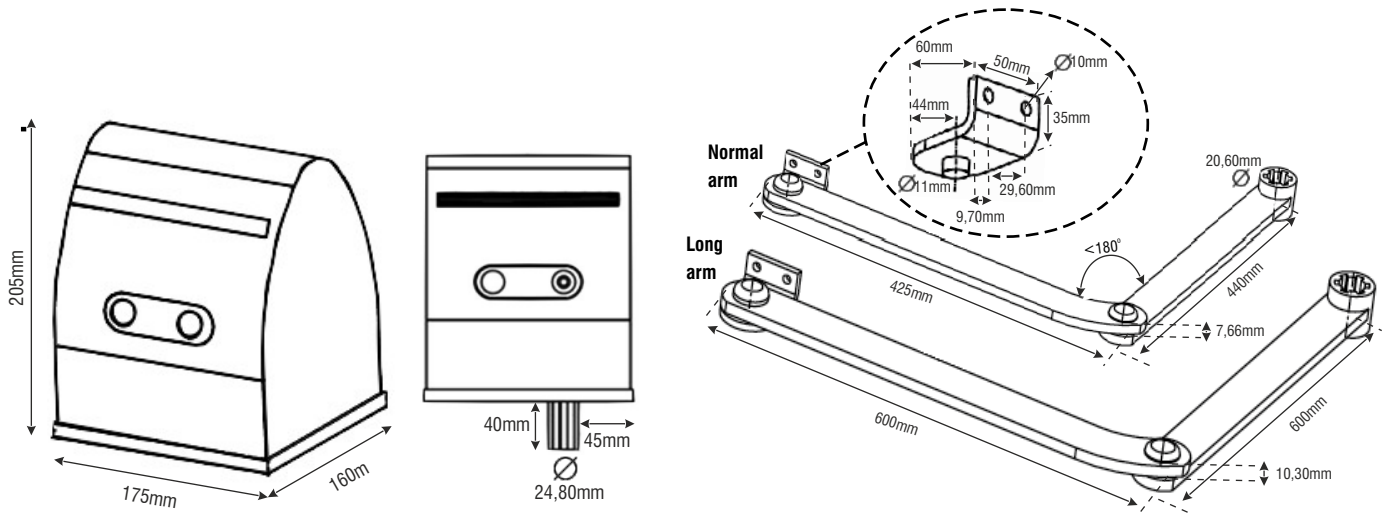

Assembly quotas

Angle (A)	Dimensions(B)
90°	250mm
120°	59mm

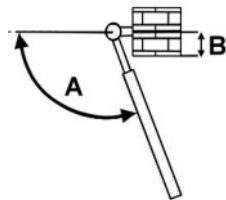

Technical Characteristics

Designation	Swing Gate Motor (MB032)
Motor	24Vdc motor with mechanical unlock
Power	145W
Absorbed current	6A
Motor rotations	1800 RPM
Work Frequency	Intensive use
Maximum Opening Angle	120°
Maximum Weight per Sheet	200 Kg
Minimum Length per Sheet	1 m
Maximum Length per Sheet	2,5 m
Temperature	-10°C to +60°C
Noise	LpA <= 50db (A)
Kit Weight	21,30 Kg
Protection Index	IP54

Charact. Tech. of the Control Board

Designation	Control Board (PL025)
Power supply	230Vac - 50Hz
Backup Battery	2 x 12V for emergency operation in case of power failure (Optional)
Receiver	Rolling Code, 433.92 MHz, 200 Emitters
Temperature	-20°C to +50°C
Electric lock (contact)	12/24 Vdc/Vac Maximum current 3A
Protection Index	IP65
Box dimensions	H 255 x W155 x D100 mm

Control Board (Optional)



PL025FE - OMNIPRO
power board for 2 24Vdc
Swing Gate Motors (Prepared
for 12Vdc Electric Lock - 3A)

Swing Gates Motors

BASSET MB035

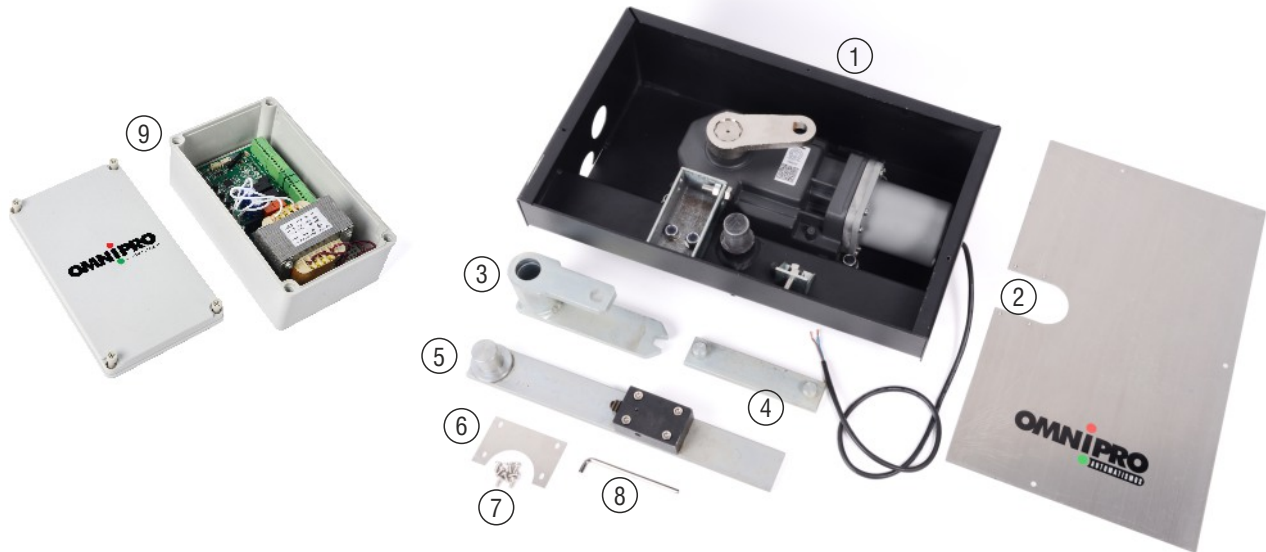

- 1 - Foundation box
- 2 - Cover for foundation box
- 3 - Motor support
- 4 - Crank to couple the motor to the gate
- 5 - Fixing bracket to the gate with unlocking system
- 6 - Cover for gate support
- 7 - Cover fixing screws
- 8 - Gate unlock key
- 9 - Control board with receiver for two arms (PL 025)

Motor for residential doors

- Able to move doors up to 2,5 meters and 250Kg per leaf in an extremely fast and safe way
- High breakaway torque to break inertia
- Slowdown in opening and closing

Easy installation and configuration

- Multi-level force adjustment for safe opening and closing, with obstacle detection and crush prevention
- Reduced dimensions for easier installation
- Simplified operability setup

Automatic closing

- Adjustable closing time up to 2 minutes

Pedestrian mode

- 2 Motors just opens Motor 1
- 1 Engine only opens at 50% of course

Dual power supply

- Additional protections against mains variations and overloads
- 2 optional 12V 7A/h batteries with capacity up to 20 operations

Safety certifications and standards

- CE (Europe)

Automatic learning mode

- 1 or 2 motors

Closure photocells

- Ensures security in closing operations

24
volts

EN
12445
12453
CONFORME

CE

Swing Gates Motors

BASSET MB035 Underground Motor

BASSET (MB036)

Swing Gate Motor Kit

- 1 Control board with receiver for two arms (PL025);
- 2 Swing Gate Motor;
- 1 watertight outer wall box;
- 2 4-channel Rolling Code transmitters;
- 1 pair of photocells;
- Connection and fastening accessories.

Models

	Article	Description	Installation	Max. length by sheet	Max. weight by sheet
BASSET 24 Vdc	MB036	Kit BASSET (2 arms)	Reversible	2,5m	250Kg
	MB037	Kit BASSET (1 arm)			
	MB035	Motor BASSET (1 arm)			

Dimensions

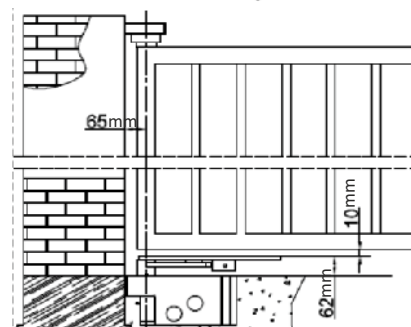
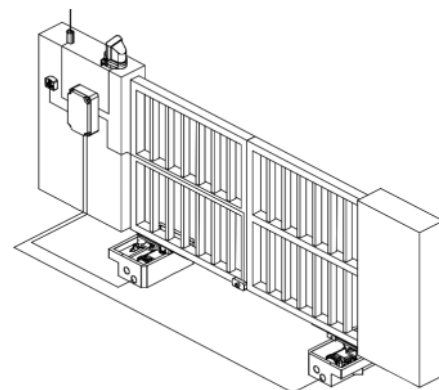
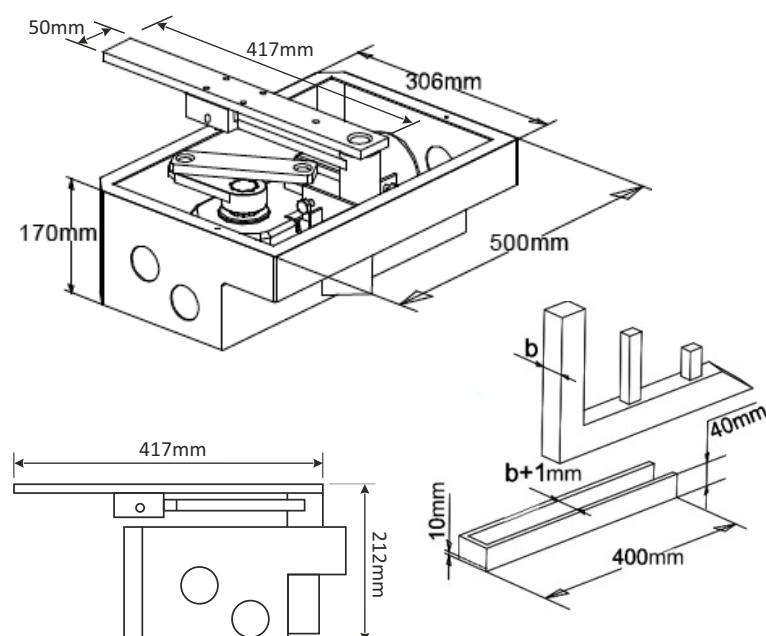

Technical Characteristics

Designation	Swing Gate Motor (MB036)
Motor	24Vdc motor with mechanical unlock
Power	132W
Absorbed current	5,5A
Motor Operating Speed	1450 RPM
Work Frequency	Intensive use
Maximum Opening Angle	110°
Maximum weight per sheet	250 Kg
Minimum length per sheet	1 m
Maximum length per sheet	2,5 m
Room temperature	-20°C to +55°C
Thermal protection	140°C
Kit Weight	52,6 Kg
Protection Index	IP67

Charact. Tech. of the Control Board

Designation	Control Board (PL025)
Power supply	230Vac - 50Hz
Backup Battery	2 x 12V for emergency operation in case of power failure (Optional)
Receiver	Rolling Code, 433.92 MHz, 200 Emitters
Temperature	-20°C to +50°C
Electric lock (contact)	12/24 Vdc/Vac Maximum current 3A
Protection Index	IP65
Box dimensions	H 255 x W155 x D100 mm

Control Board (Optional)



PL025FE - OMNIPRO
power board for 2 24Vdc
Swing Gate Motors (Prepared
for 12Vdc Electric Lock - 3A)



Garage Doors Motors





- 1 - OMNI II roof motor
- 2 - Mounting Brackets
- 3 - Cart with unlock lever
- 4 - Fixing plate for the rail to the lintel
- 5 - Gate fixing plate
- 6 - Ceiling gutter fixing plate
- 7 - Motor-rail fixing plate
- 8 - Unlocking lever cord
- 9 - Main rod
- 10 - Secondary rod
- 11 to 15 - Fixing accessories



Revolutionary operating mode and design

- Motors with chain or belt
- Manufacturing precision and high-quality guarantee less maintenance
- Silent opening and closing operations with millimeter precision
- Unlock / Lock in any position

600N/1000N motor and 1200N power

- Able to safely and silently move the biggest and heaviest doors, (10m², 15m² and 18m²)
- 2 12V Batteries - 1.3Ah - Optional

Easy Installation and Configuration

- Assembly in a few minutes and almost no need to change settings
- Four learning cycles, time and force calibration for opening and closing cycles

Adaptive anti-crush

- Automatic detection of the need for power readjustment for always safe and efficient operation
- Automatic adjustment of the force required to open and close independently
- Obstacle detection and crush prevention

Operating speed

- Setting the closing and opening speed independently
- Soft start and stop

Automatic closing operation

- Adjustable up to 2 minutes

Safety certifications and standards

- CE marked and in accordance with European standards EN12445 /EN12453

Built-in radio frequency receiver

- Secure encoding based on Rolling Code Keelok 433Mhz encryption (20 users)

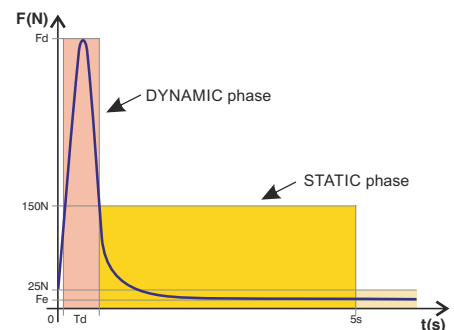

24
volts

EN
12445
12453
CONFORME

CE

Garage door Motor Kit

- 1 Motor with control board and built-in receiver;
- 1 Gutter;
- 2 4-channel Rolling Code transmitters;
- Mounting accessories.

Motor Dimensions

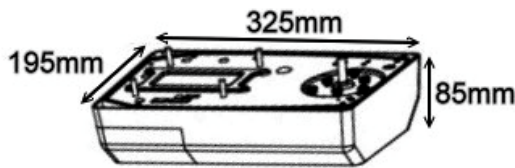

Motor sizing

- **OMNI 600** - Area $\leq 10 \text{ m}^2$
- **OMNI 1000** - Area $\leq 15 \text{ m}^2$
- **OMNI 1200** - Area $\leq 18 \text{ m}^2$



Available Gutters

Artigo	Description	Traction	Gutter	Gutter Dimension	Maximum height of the door
MT019	Kit OMNI 600Nm	Belt	Split	3000 mm	2355 mm
MT016	Kit OMNI 600Nm	Chain	Split	3000 mm	2385 mm
MT020	Kit OMNI 1000Nm	Belt	Split	3000 mm	2355 mm
MT017	Kit OMNI 1000Nm	Chain	Split	3000 mm	2385 mm
MT018	Kit OMNI 1200Nm	Chain	Split	3000 mm	2385 mm
MT021	Kit OMNI 600Nm	Chain	Entire	3150 mm	2535 mm
MT022	Kit OMNI 1000Nm	Chain	Entire	3150 mm	2535 mm
MT023	Kit OMNI 1200Nm	Chain	Entire	3150 mm	2535 mm
MT024	Kit OMNI 600Nm	Chain	Entire	4000 mm	3385 mm
MT025	Kit OMNI 1000Nm	Chain	Entire	4000 mm	3385 mm
MT026	Kit OMNI 1200Nm	Chain	Entire	4000 mm	3385 mm
MT027	Kit OMNI 600Nm	Chain	Entire	5000 mm	4385 mm
MT028	Kit OMNI 1000Nm	Chain	Entire	5000 mm	4385 mm
MT029	Kit OMNI 1200Nm	Chain	Entire	5000 mm	4385 mm
CC007	Gutter	Belt	Split	3000 mm	2355 mm
CC006	Gutter	Chain	Split	3000 mm	2385 mm
CC008	Gutter	Chain	Entire	3150 mm	2535 mm
CC004	Gutter	Chain	Entire	4000 mm	3385 mm
CC005	Gutter	Chain	Entire	5000 mm	4385 mm

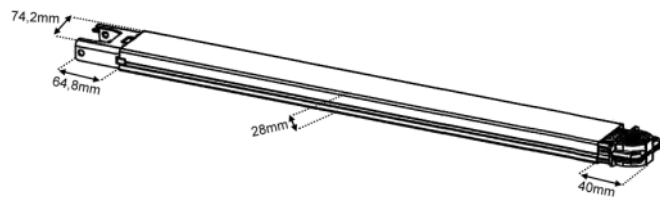

Technical Characteristics

Designation	OMNI 600	OMNI 1000	OMNI 1200
Power supply	220-240V => 50Hz / 110-127V => 60Hz		
Maximum force	600 N	1000 N	1200 N
Door Weight	80 Kg	100 Kg	120 Kg
Traction	Chain/Belt		Chain
Speed	0,16 m/s		0,14 m/s
Presence light	Included		
End of course	Electronic		
Noise	LpA ≤ 55 dB (A)	LpA ≤ 60 dB (A)	
Transformer	230Vac - 24Vac		
Frequency	433,92 Mhz		
Codification	Rolling Code (7520 combinations)		
Issuers incl.	2 units		
Number of Issuers in memory	20 units		
Temperature	-40°C to +50°C		
Safety	Smooth opening and closing Anti crush protection		
Dual Encoder	Yes		
12v 1.3Ah batteries	2 units (optional)		
Protection Index	IP20		

Garage Doors Motors

Accessories



CC001
3000mm Split Rail
with included chain for OMNI Motor

CC002
3000mm Split Chute
with included belt for OMNI Motor



EC001
1000mm Belt Gutter Extension
for OMNI Motor

- 1 - Gutter
- 2 - Mounting Brackets
- 3 - Chain and Belt

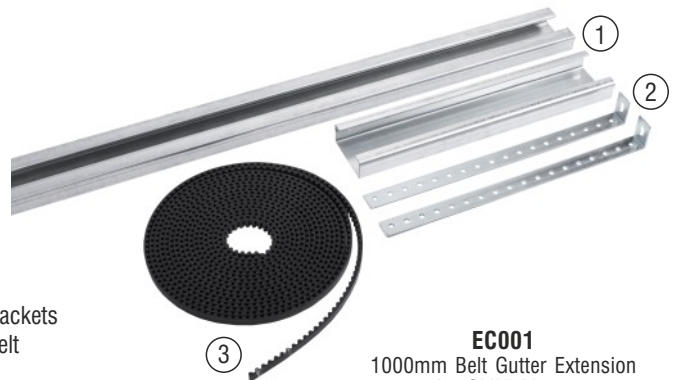

EC001
1000mm Belt Gutter Extension
for OMNI Motor



CC006
3000mm Split Rail
with included chain for OMNI II Motor



CC007
3000mm Split Chute
with Belt included for OMNI II Motor



C0002
1/2"x1/8" Current
for OMNI Ceiling Motor (m)



AC004
Motor Ceiling Disconnect



CC009
OMNI II Ceiling
Motor Rail Union



AC005
Roof Motor Battery Holder

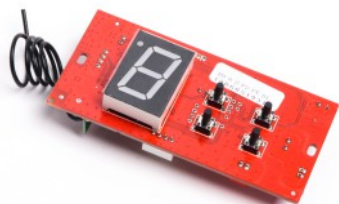

PL013
24V DC Digital power board
for OMNI Ceiling Motor



PL014
24V DC Power Board
for OMNI Ceiling Motor

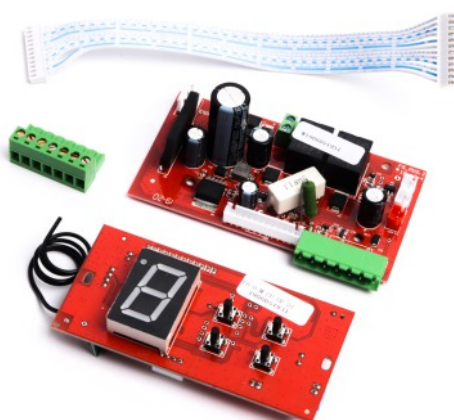

PL031
Condominium Mode 24V DC power boards
Kit for OMNI Ceiling Motor

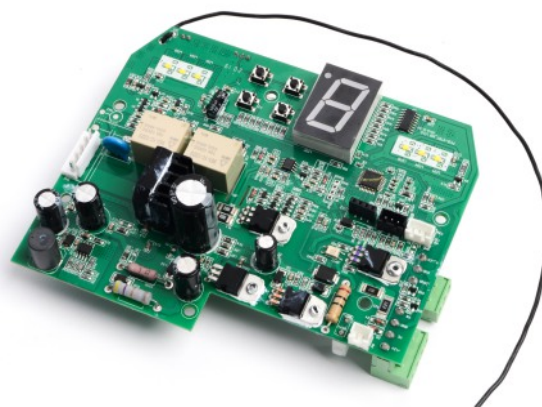

PL032
24V DC power board
for OMNI II Ceiling Motor



MT030
Toroidal Transformer 24V 150W
for Ceiling Motor OMNI II 1200Nm



MT031
18V DC Gearmotor for OMNI II
1200Nm Ceiling Motor



Industrial Motors





- 1 - MPRO motor
- 2 - Chain
- 3 - Motor fixing plate
- 4 - Padlock support plate
- 5 - Protection ring
- 6 - Peg/key
- 7 - Wrench for tightening the protective ring
- 8 - Motor fixing screws

Shaft drive motor for residential and industrial doors

- Able to move doors up to 40 m² extremely quickly and safely
- High breakaway torque to break gate inertia
- The motor ensures that the door is locked when it is open or closed

230
volts

380
volts



Easy installation and configuration

- Ease of installation, configuration, makes it ideal for all types of sectional doors

Automatic closing

- Adjustable closing time up to 2 minutes

Dual power supply

- Additional protections against mains variations and overloads

Safety certifications and standards

- CE (Europe)

Man Present Mode

- Gate only closes when pressing down button
- Automatic closing is inactive

Service door

- With the service door sensor, it guarantees that whenever the door is open, the automation is not working.

Industrial Motor Kit

- 1 Control board with receiver;
- 1 Motor;
- Connection and fastening accessories;
- Connection and fastening accessories;
- 1 Waterproof wall box.

Dimensions

For all MPRO versions

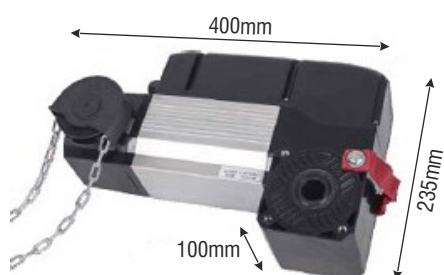

PL028

OMNIPRO power board
for 380V AC Three-Phase
Industrial Motor



PL029

OMNIPRO power board
for 230V AC Single Phase
Industrial Motor

Technical Characteristics / Control Board

Designation	MPRO 60 MI009	MPRO 90 MI010	MPRO 60 MI004	MPRO 100 MI005	MPRO 150 MI006
Power supply	230/50Vac/HZ		380/50Vac/HZ		
Power	500W	600W	300W	500W	650W
Idle rotation	24RPM				
Door area	Up to 25m²	Up to 30m²	Up to 25m²	Up to 30m²	Up to 40m²
Speed	≈0.23m/s				
Initial torque	60 N.m	90 N.m	60 N.m	100 N.m	150 N.m
Maximum limit of the end of the course	20 motor rotations				
Thermal protection	120 °C				
Reducer	1:10				
Type of lubrication	Oil				
Noise	≤55dB				
Manual operation and unlocking	Chain				
Shaft diameter	25,4mm				
Room temperature	-20 °C a +45 °C				
Protection index	IP54				
Power supply protection (Swing / Overloads)	Yes				
Receiver (Rolling Code 433Mhz)	Yes				
Designation	Board (PL019)		Board (PL005)		
Power supply	Single phase		Three-phase		
Power	750W		1000W		
Box dimensions	H295 x W210 x D115mm				



Rolling Shutter Motors



Rolling Shutter Motors

Single motor

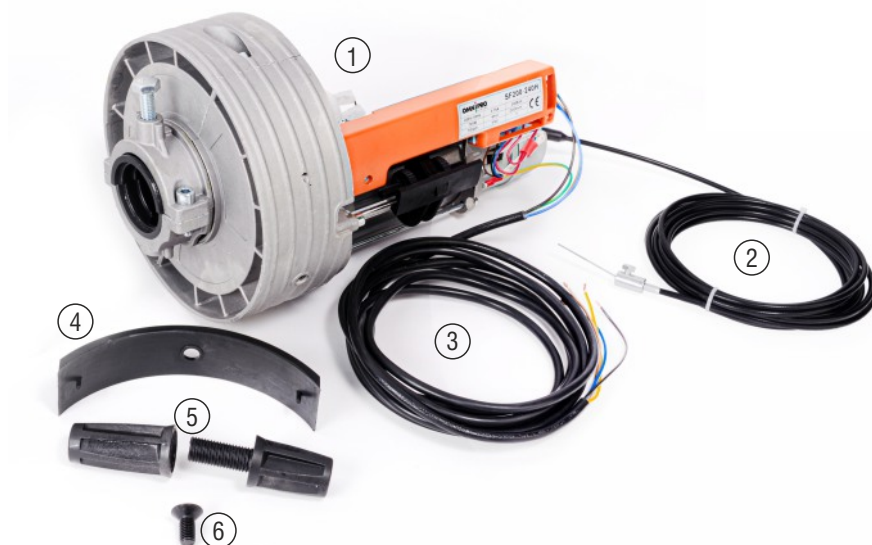

- 1 - GR single motor with electrobrake
- 2 - Cable with unlocking sleeve
- 3 - Power supply cable
- 4 - 220mm drum adapter
- 5 - Unlocker
- 6 - 220mm drum adapter

Single motor for residential and industrial doors

- Able to move doors up to 180kg extremely quickly and safely
- High breakaway torque to break inertia
- Single-motor with electrobrake that secures the door lock when it is open or closed

Easy installation and configuration

- Based on independent modules that make maintenance operations quick and easy.

Automatic closing

- Adjustable closing time up to 2 minutes

Man Present Mode

- Gate only closes when pressing down button
- Automatic closing is inactive

Dual power supply

- Additional protections against mains variations and overloads

Safety certifications and standards

- CE (Europe)

Manual unlocking system

- To open the door in case of power failure

230
volts

CE



- 1 - GR twin engine with electrobrake
- 2 - Cable with unlocking sleeve
- 3 - Power cable
- 4 - Unlocker
- 5 - Grid fixing screw

Twin engine for residential and industrial doors

- Capaz de mover de uma forma extremamente rápida e segura portas até 320kg
- Torque de arranque elevado para quebrar a inércia
- Bimotor com eletrofreio que assegura o bloqueio da porta quando está aberta ou fechada

Easy installation and configuration

- Based on independent modules that make maintenance operations quick and easy.

Automatic closing

- Adjustable closing time up to 2 minutes

Man Present Mode

- Gate only closes when pressing down button
- Automatic closing is inactive

Dual power supply

- Additional protections against mains variations and overloads

Safety certifications and standards

- CE (Europe)

Manual unlocking system

- To open the door in case of power failure



Rolling Shutter Motors

Rolling Shutter Motors

Rolling Grilles Motors Kit

- 1 Motor with electrobrake and manual release system;
- 1 Control board with receiver;
- Connection and fastening accessories;
- 1 waterproof wall box.

Dimensions

GR009 → SF200-80

GR010 → SF200-120

GR011 → SF200-240

GR003 → SF200-160

GR003 → SF200-360

GR011 → SF240-420

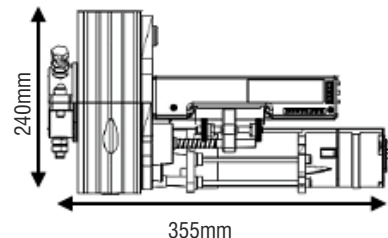
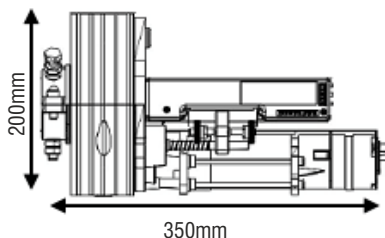
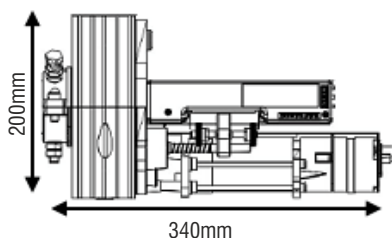

Technical Characteristics / Control Board

Description	GR009 SF200-80	GR010 SF200-100	GR003 SF200-160	GR011 SF200-240	GR012 SF200-360	GR004 SF240-420
Binary	80N.m	120N.m	160N.m	240N.m	360N.m	420N.m
Power supply	230Vac					
Motor	1			2		
Drum	ø200mm					ø240mm
Pipe	ø60mm					ø76mm
Power	380W	430W	580W	730W	1200W	1350W
Chain	1.70A	1.90A	2.60A	3.20A	5.20A	6A
Speed	10RPM					9.5RPM
Supported weight	60Kg	90Kg	120Kg	180Kg	270Kg	320Kg
Condenser	12μF	16μF	20μF	24μF	40μF	
Engine Weight	8Kg	8.5Kg	9.5Kg	10Kg	12.5Kg	14Kg
End-of-course adjust. up to	6m					
Maximum grid area *	6m ²	9m ²	12m ²	16m ²	27.5m ²	30m ²
Thermal protection	160°C					
Room temperature	-20°C to +85°C					
Insulation class	B					
Degree of protection	IP00					

* Check the weight of the grid, hexagonal model - 14 kg/m², micro-perforated and flat model - 17 kg/m² and Nuppy model - 20 kg/m²

Charact. Tech. of the Control Board

Designation	PL021
Power supply	230 Vac - 50 Hz
Maximum power	1500 W
Receiver memory	200 emitters
Receiver frequency	433.92 MHz
Protection index	IP65
Box dimensions	H175mm x W130mm x D80mm



PL021
OMNIPRO power board for 230V AC
Winding Grid Motor



AC031
Electrobrake for Winding Grid Motor
(Single Motor)

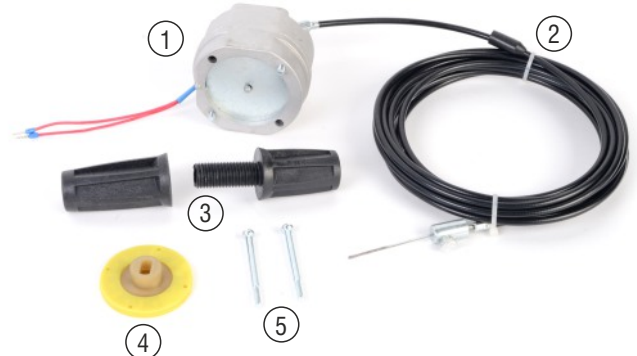

AC032
Electrobrake for Winding Grid Motor
(Bimotor)



AC030
Cable Declutch Motor Grid Winding



AC034
Limit Stops for Grid Winding Motor
(Single Motor)



PA002
Electrobrake for Winding Grid Motor
(Single Motor)

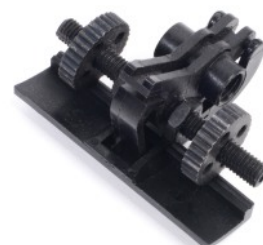

AC033
End Switch Actuator
for Grid Winding Motor



Glass Door



PV010 Kit Composition

- Aluminum profile with nylon guide, cover and tops;
- Belt, belt union and tensioner;
- 2m aluminum clamp per Kit, trolleys and ground guide;
- Electronic controller;
- 24Vdc brushless BLDC motor (brushless);
- 6-position switch selector;
- Batteries charger;
- 2 x 12Vdc batteries;
- 24Vdc electric latch;
- Interior motion and presence radar;
- Outdoor motion radar;
- Mounting accessories and stops.



RA008
Dual Technology Radar



RA007
Motion Radar



SE006
Key Selector



TR005
Electric Latch



PV014
Glass Door Controller



PV015
Motor



BT008
Backup Batteries

The Basenjoy i9 automatic glass door

is equipped with the most advanced security and control systems to ensure optimal operation. The **high technological level**, quality and reliability, allows achieving the perfect resolution of both technical and aesthetic aspects, having as a fundamental aspect the **energy efficiency** of the automation. This automatism is capable of satisfying the requirements in different commercial environments with a **capacity of up to 270 kg** of total weight of the two leaves. With an elegant design and easy installation, this automation is versatile for all automation professionals, who are looking for solutions with low intervention cost and simplicity in carrying out maintenance.



Conception innovante

Profile with 105mm height and maximum length of 5400mm is the ideal dimension for a sophisticated automation, paying special attention to simplicity in installation and maintenance. The modern aesthetics of the Basenjoy i9 automatism embraces the demands of modern buildings.

Gutter dimentions

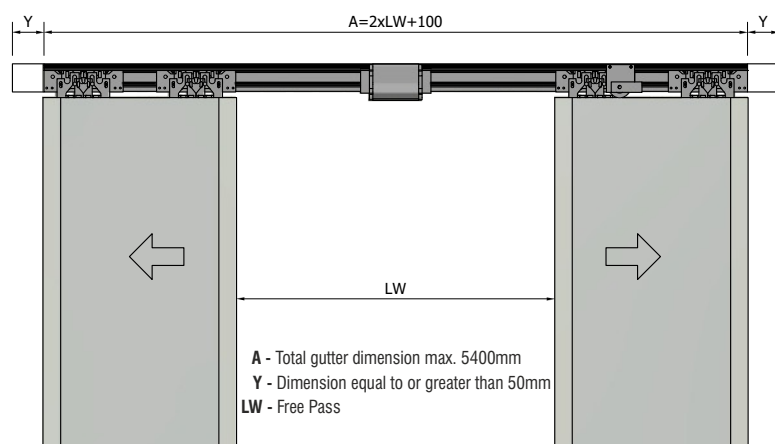

Description	Free Pass (LW)	Sheet weight
1 Sheet	700 - 1500mm	1 x 180Kg
2 Sheets	800 - 2700mm	2 x 135Kg

Clamp Dimensions

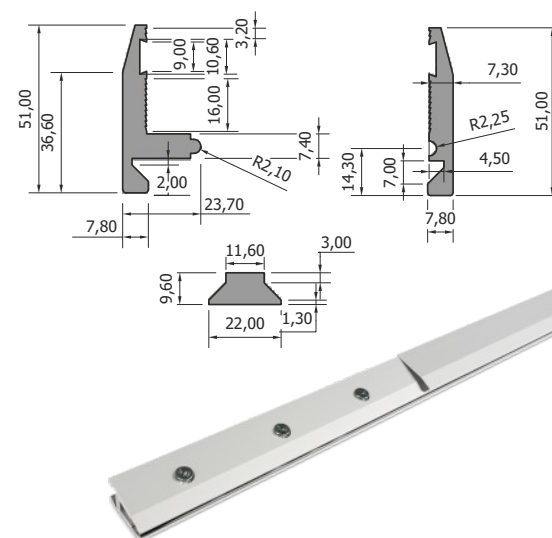

Profile dimensions

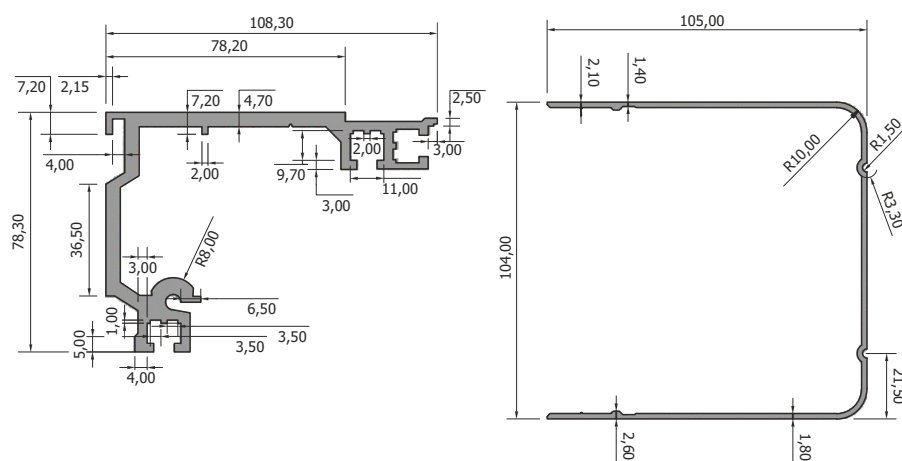

Main Installation Functions

Power supply	230Vac - 50Hz
Battery	2 x (1,3Ah - 12Vdc)
Motor power supply	8A - 24Vdc
Accessory power supply / Electric latch	0,3A-24Vdc/0,2A-24Vdc
Power regulation	✓
Obstacle detection with sensitivity adjustment	✓
Opening and closing speed adjustment	✓
Full opening / partial opening / full closing	Selectable
Programmable automatic closing time	✓
Sens de rotation du moteur réglable	✓
Programmable Output Relay	✓
Reverse security with presence sensor	Standard EN16005
Safety Devices Test Function	Standard EN16005

Technical Characteristics

Designation	1 Sheet	2 Sheets
Movement management	Encoder	
Motor power	200W	
Operating force	150N	
Max. relative humidity	90%	
Room temperature	-25°C to +50°C	
Battery life	Up to 15 minutes	Up to 10 minutes
Protection index	IP23	
Door weight	≤ 180Kg	≤ 2x135Kg
Free Pass	700mm~1500mm	800mm~2700mm
Speed	0.12 - 0.70m/s	
Duration test	1 million cycles	
Product dimensions	H 105 x W 185 x D 5400 mm	

Glass Door Accessories



SC002
Key Selector



TM003
Keypad/Multifunction Selector with LCD Key



PN002
Aluminum Clamp (m)

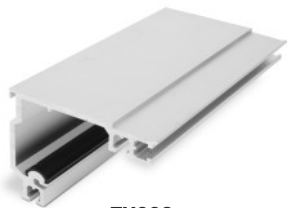

TV002
Profile



TV002
Cover



TV002/PV012
Assembly



PV012
Tops for Aluminum Profile



PV007
BASENJY T1000 Glass Door
Control Plate



PN001
Aluminum Gripper (Set. 2Un)



TR001
Electric Latch



PV011
Solo Guide



PV013
BASENJY i9 Belt Union



PV016
BASENJY i9 Belt Tensioner



PV017
BASENJY i9 Cart

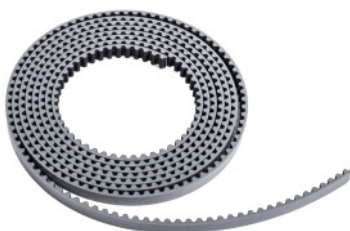

CD001
Basenjoy Timing Belt (m)



PV019
BASENJY Timing Belt i9 (m)



PV008
BASENJY T1000 Engine



FC003
Photocell for Glass Door



TR002
Controller for Electric Latch



RX004
Dual Radar MSDT
Gray Technology



TM001
Keyboard/Multifunction Selector



TM002
Keyboard/ LCD
Multifunction Selector

Glass Door

1 and 2-leaf Pedestrian Door MB011 | MB012



MB011 - Arms motor for 1 sheet up to 1m and 100kg/sheet

- Smooth opening and stopping with adjustable deceleration time



MB012 - Arm motor for 2 sheets up to 1.2m/sheet and 100Kg/sheet

- Smooth opening and stopping with adjustable deceleration time

Operation with Electric Latch

- The electric latch acts whenever the door is closed

Course

- Automatic learning mode
- Opening angle up to 90°

Closure photocells

- Ensures security in closing operations

Control of firefly LED

- Configurable time and advance notice
- Automatic learning mode

Adaptive anti-crush

- Adjustment of the force required to open and close securely
- Obstacle detection and crush prevention

Dual power supply

- Additional protections against mains variations and overloads
- 2 optional 12V, 7Ah batteries with capacity up to 30 operations

Safety certifications and standards

- CE marked and in accordance with European standards EN12445 /EN12453

24
volts

EN
12445
12453
CONFORME



Description

- Various modes of operation of the automation (radars, push buttons, card reader or remote control)
- Adjustable automatic closing time;
- Adjustable opening and closing speed;
- Adjustment of the opening and closing slowdown point;
- Optional security system, which allows the connection of batteries in case of power failure

Dimensions

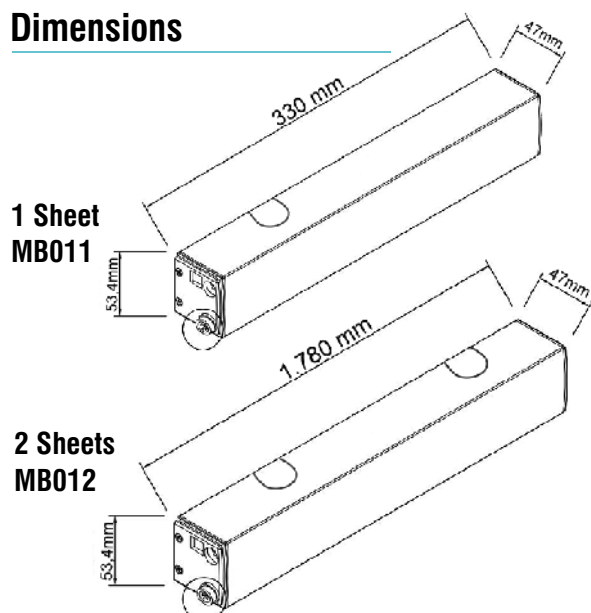

Technical Characteristics

Designation	MB011	MB012
Number of sheets	1	2
Maximum length per sheet	500 to 1000 mm	500 to 1200 mm
Maximum weight per sheet	100 Kg	2x 100 Kg
Opening angle	0° to 90°	0° to 90°
Brushless DC Motor	24Vdc, 10W	2x24VDC, 2x10W
Power supply	220Vac ± 10% 50Hz	220VAC ± 10% 50Hz
Accessory supply	12Vdc, 24Vdc	12Vdc, 24Vac
Weight	5 Kg	12 Kg
Frequency of use	Intensive	Intensive
Installation	Reversible	Reversible



24
volts

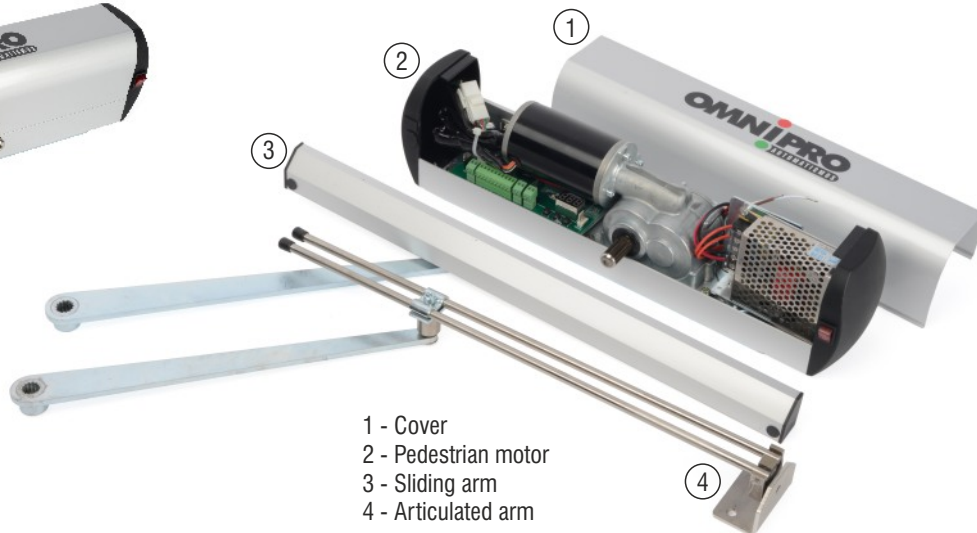

- 1 - Cover
- 2 - Pedestrian motor
- 3 - Sliding arm
- 4 - Articulated arm

Description

- Various modes of automation operation (radars, push buttons, card reader or remote control)
- Adjustable automatic closing time;
- Adjustable opening and closing speed;
- Adjustment of the opening and closing slowdown point;
- Optional security system, which allows the connection of batteries in case of power failure.

Technical Characteristics

Designation	MB043
Power supply plug	230Vac
Engine voltage	24Vdc
Absorbed Power	40W
Maximum opening angle	120°
Maximum sheet length	2,5m
Max . weight of the leaf	250Kg
Opening/closing slowdown	Yes
Automatic calibration	Yes
Open/close crush detection	Yes
Indoor/outdoor radar	Yes
Interconnection with another automation	Yes
Electric Latch	Yes
Connection with central alarm	Yes
Battery kit in case of power failure	24V (2x12V/7Ah) Optional
Frequency of use	Intensive
Room temperature	-15°C a + 60°C
Protection index	IP44
Mounting	Reversible

Opening direction

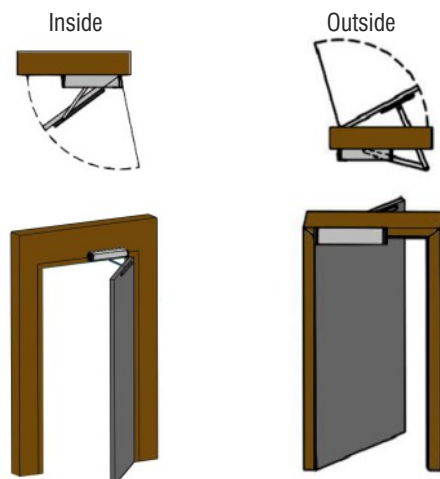

Dimensions

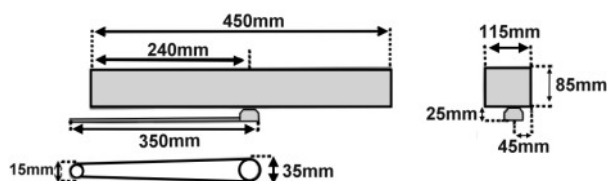

Assembly quotas

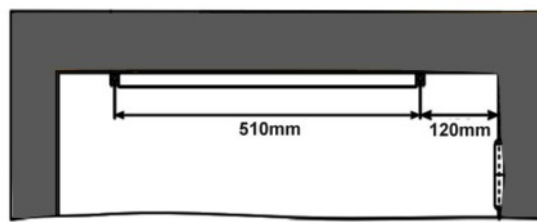

Barriers





BA005
Aluminum Barrier Rod for
SECTOR 6m Barrier



BA001
Barrier Kit SECTOR
6m Right



BA002
SECTOR Barrier Kit
6m Left



BA006
SECTOR Barrier Kit
with 6m Right
LED Display



BA007
SECTOR Barrier Kit
with LED Display 6m Left



BA014
Hinged Rod for SECTOR
Barrier up to 5m



BA010
SECTOR Barrier Kit
with Articulated Rod
up to 5m Right



BA011
SECTOR Barrier Kit
with Articulated Rod
up to 5m Left



BA020
Articulated Rod Mechanism



BA016
SECTOR Barrier Kit
with LED Display
Rod Art. 5m Right



BA017
SECTOR Barrier Kit
with LED Display
Rod Art. 5m Left

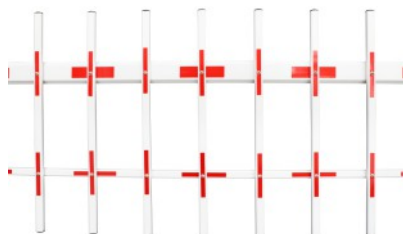

BA015
Skirt for Barrier Kit up to 4m



BA012
SECTOR Barrier Kit
with Rod Skirt
up to 4m Right



BA013
SECTOR Barrier Kit
with Rod Skirt
up to 4m Left



BA018
SECTOR Barrier Kit
with LED Display,
4m Right Skirt

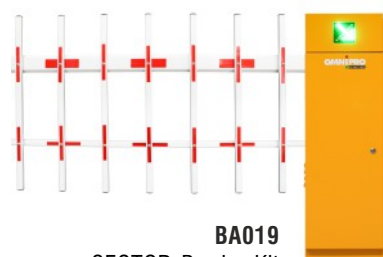

BA019
SECTOR Barrier Kit
with LED Display,
4m Left Skirt

Barriers Kit

- 1 control panel with receiver;
- 2 Issuers;
- 1 Pair of photocells;
- Connection and fixation accessories;

Dimensions

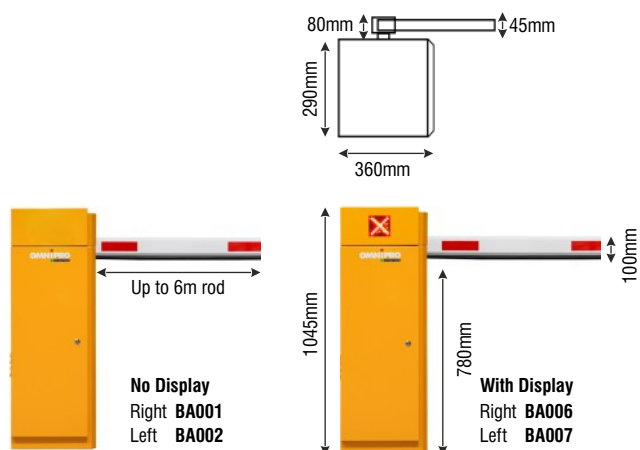

Engine Technical Characteristics

Designation	BA001/BA002
Room temperature	-25°C to +85°C
Power supply	230Vac 50Hz
Power	100W
Relative humidity	≤ 90%
Sender range	≥ 30m
Weight	65Kg
Receiver	Rolling Code Keelok 433Mhz
Number of configurable receivers	200
Opening time with 6m barrier	6s
Opening time with 3m barrier	3s

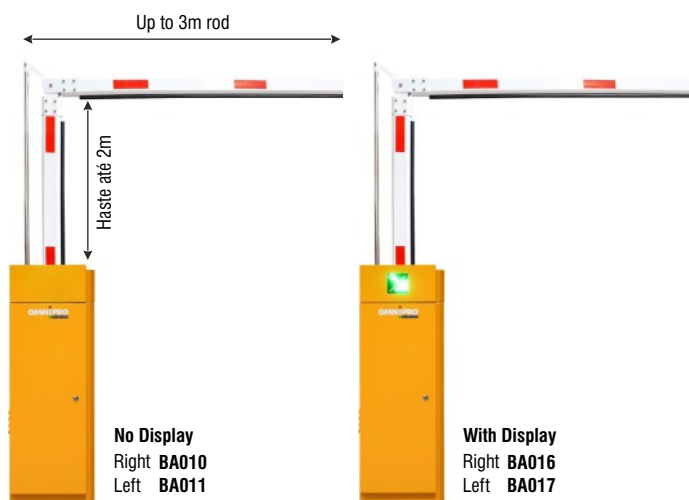

PL030

OMNIPRO power board for 230V AC Barrier

Charact. Tech. of the Control Board

Designation	PL030
Power supply	230 Vac - 50 Hz
Maximum power	1500 W
Receiver memory	200 emitters
Receiver frequency	433.92 MHz
Protection index	IP65

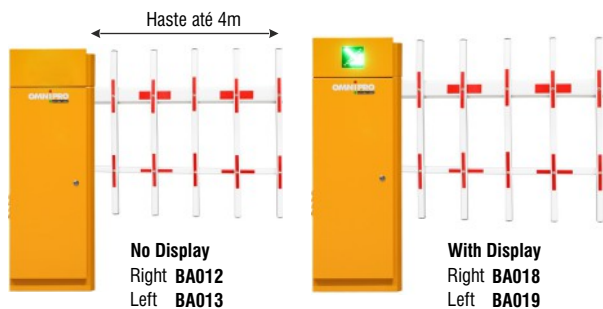

Bollards





PL027
OMNIPRO Frame for
Electromechanical bollard 230Vac



PT002
Electromechanical bollard
Stainless steel 168x600mm



PT001
Manual Retractable Pole
Stainless steel 114x600mm

Description

The electromechanical bollard was designed to control access to a highly secure location, guaranteeing pedestrians access and blocking access to vehicles.

Main features are:

- A. Made of stainless steel;
- B. Electromechanical working mode;
- C. Resists very strong impacts;
- D. Height above ground: 600 mm.

Dimensions

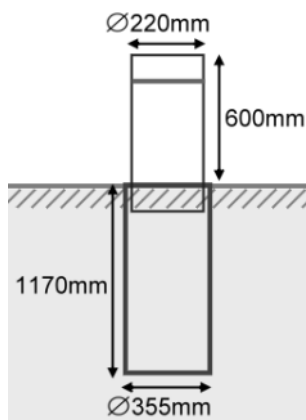

Technical Characteristics

Designation	PT002
Power supply	230Vac
Safety Unlock Voltage	12Vdc
Operating time	3 - 5s
Material	Stainless steel
Box dimensions	H370 x W240 x D130mm

Access Control



**CA004**

5A Power Supply for Access Control System

CA014
TCP/IP Network Controller for 1-Port Access Control

**CA007**

RFID Card Reader IP68

**CA005**RFID Access Card
(key holder)**CA013**

125KHz RFID Access Card

**CA010**Long Range Optical
Access Card**CA009**

Long Range Optical Reader



GSM GS001 Module Kit

- 1 GSM modem;
- 1 GSM antenna;
- 1 Adapter (230Vac/12Vdc);
- Configuration - Android Application, SMS Commands and PC Software;
- Battery included 3.7V / 900mAh.



Technical Characteristics

Designation	Módulo GS001
GSM frequency	900/2100 MHz 850/1900 MHz 850/2100 MHz
Digital Inputs	2
Relay Output	240Vac / 3A
Siren Exit	12Vdc
No. of users	999
Input power	230Vac
Outlet power	12Vdc
Energy consumption	12Vdc / Max. 50mA
SIM card	Suport (not included)
GSM antenna	50 Ω
Room temperature	-20°C a 60°C
Humidity	90% condensing free relative humidity
Dimensions	H130 x W74 x D27 mm
Weight	260g
Battery	3,7 V / 900mAh

GSM GS007 Module Kit

- 1 GSM modem;
- 1 GSM antenna;
- 1 Adapter (230Vac/12Vdc);
- Configuration - Android Application, SMS Commands.



Technical Characteristics

Designation	Módulo GS007
GSM frequency	Quad-band 850/900/1800/1900MHz
Relay Output	240Vac / 3A NC/NO
No. of users	200
Energy consumption	12Vdc 4 / Max. 50mA
SIM card	Suport (not included)
GSM antenna	50 Ω
Room temperature	-20°C a 60°C
Humidity	90% condensing free relative humidity
Weight	160g
Dimensions	H110 x W90 x D27 mm

Módulo GSM GS004



Technical Characteristics

Designation	Módulo GS004
GSM frequency	Quad-band 850/900/1800/1900MHz
Communication	With all Omnipro power supply frames
No. of users	50
Energy consumption	12Vdc / Max. 50mA
SIM card	Not included
GSM antenna	Included
Temperature	-20°C a 60°C
Humidity	90% condensing free relative humidity
Weight	400g
Dimensions	H125 x W77 x D70 mm

Technical Characteristics

Description	RX010
Power Supply / Power Consumption	5V, 12V, 24V DC / 80mA
Maximum voltage/contact current at output relay	250Vac / 10A
Maximum contact power on the output relay	2200 W
Wi-Fi Frequency	2.4GHz, b/g/n
Pulse time to actuate the relay (adjustable in APP)	Minutes or seconds
Function to schedule relay actuation (adjustable in APP)	7 days a week
Relay actuation timer (adjustable in APP)	Hours or minutes
Continuous relay operating cycle (adjustable in APP)	Hours or minutes
Number of users (free application)	Até 20
Room temperature	-40°C to +70°C
Dimensions	H20 x W40 x D70 mm



RX010
Single Channel Receiver
5/12/24V WIFI 2.4GHz

Technical Characteristics

Description	RX011
Power Supply / Power Consumption	12 - 24Vac/dc (80mA)
Maximum voltage/contact current at output relay	250Vac/ 10A
Maximum contact power on the output relay	2200W
output channels	CH1/CH2
Wi-Fi Frequency	2.4GHz, b/g/n
Pulse time to actuate the relay (adjustable in APP)	Minutes or seconds
Function to schedule relay actuation (adjustable in APP)	7 days a week
Relay actuation timer (adjustable in APP)	Hours or minutes
Continuous relay operating cycle (adjustable in APP)	Hours or minutes
Number of users (free application)	Até 20
Room temperature	-40°C to +70°C
Dimensions	H25 x W37 x D120 mm



RX011
Two-Channel Receiver
12/24V WIFI 2.4GHz

Keyboards



TE002
Wired RFID Keyboard
(2000 users)



TE004
Wireless Bi-Channel Digital
Keyboard 433.92 MHz



Technical Characteristics

Description	CA015
Supply voltage	12Vdc
Absorbed current	500mA
Optical diameter	100mm
Number of red/green LEDs	40 units /colorr
Room temperature	-40°C to +65°C
Viewing distance	≥ 300 meters
Mounting	Horizontal / Vertical

Description

- LED technology traffic light with a 90% reduction in energy consumption;
- Easy replacement of optics;
- Polycarbonate construction material;
- Color of LEDs in red and green;
- Indicated for the control of road traffic and pedestrians;
- Possibility of power supply with solar panel.

Wiring diagram

Red LED	Black Wire (Negative)
Green LED	Green Thread (Negative)
12Vdc	Red Wire (Positive)

Note: Cable Section 3x0.75mm²

Dimensions

12
volts

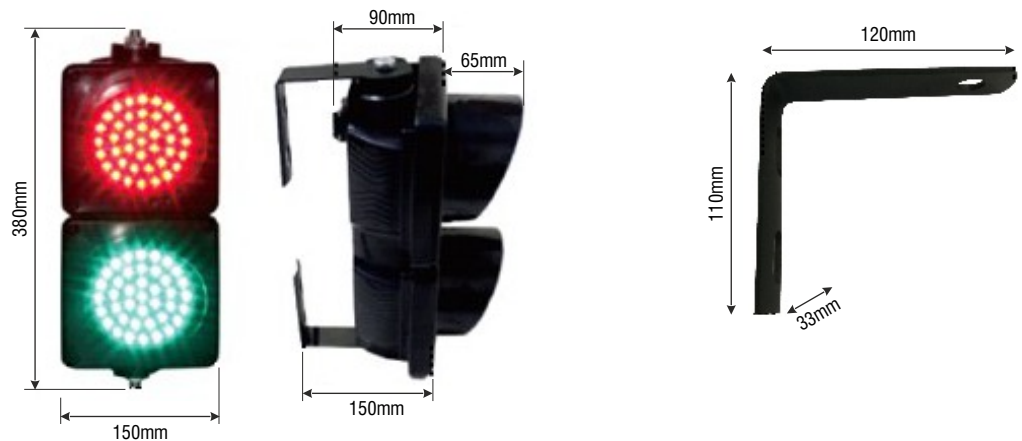



Solar Panels



Solar Panel Kit

- 1 Photovoltaic Panel;
- 24V controller;
- Does not include batteries;
- Does not include automation control panel.



PS003
Controller of Panel Solar

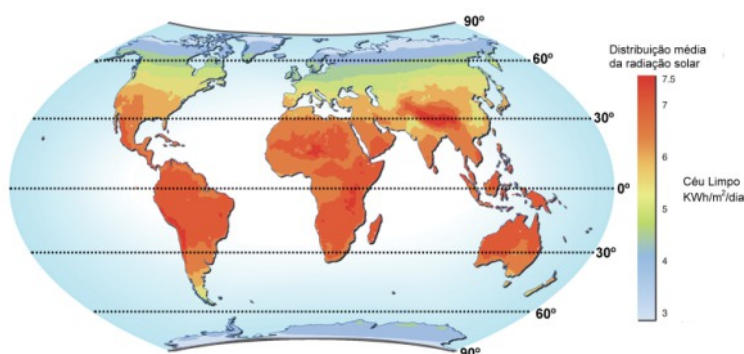
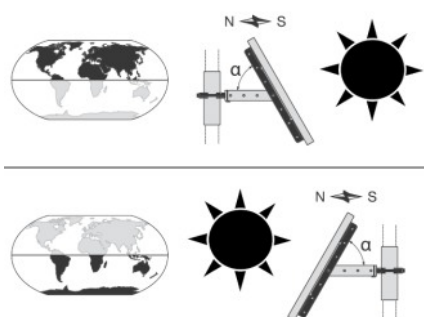
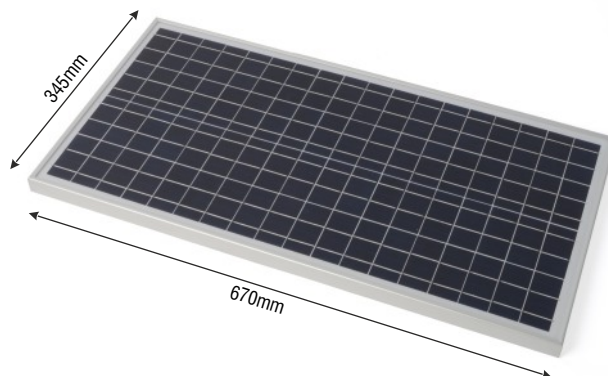

Angle table

Latitude (map)	Solar Panel Tilt Angle (α)
0° - 15°	15°
15° - 25°	Value equal to latitude
25° - 30°	Add 5° to latitude value
30° - 35°	Add 10° to latitude value
35° - 40°	Add 15° to latitude value
>40°	Add 20° to latitude value

Technical Characteristics

Designation	Controller
Rated voltage	24Vdc
Maximum input voltage of the Photovoltaic Panel	55V
Nominal chain	10A
Battery voltage charged	29,6V (24V)
Voltage at battery terminals for fast charging	28,8V (24V)
Voltage at battery terminals for normal charging	27,4V (24V)
Voltage at battery terminals for low charge	25,2V (24V)
Voltage at battery terminals disconnected	22,2V (24V)
Self-consumption	$\leq 6,01\text{mA}$ (24V)
temperature compensation	5mV/°C/2V (25°C)
Room temperature	35°C ~ +60°C
protection index	IP67
Hole Diameter	5mm
Controller dimensions	H103 x W85 x D25 mm
Weight	320g



Accessories





TX014
OMNIPRO Issuer



TX012
OMNI II transmitter
4 channels 433.92MHz RC



TX003
RC Transmitter
4 channels 433.92MHz On /Off



TX011
Transmitter
12 buttons 433.92MHz



TX004
Issuer Dupl. 4 channels
Freq. Fixed 433.92



TX005
Issuer Dupl. 4 channels
Freq. Var. (270Mhz~330Mhz)



TX006
Transmitter RC
4 channels 868,35MHz



TX010
Pro Copy Issuer



TX008
6-Button Transmitter for
BASENJO Automatic Glass Door



TX013
OMNI II Emitter Housing
(TX012)

For measuring and adjusting transmitter frequencies (TX005)



FR003
Frequencymeter 1.0GHz



AC001
Ceramic tuning wrench

Accessories

Receivers | Service port



RX007
Outdoor Receiver OMNIPRO
Rolling Code / Univ. 200mem



RX012
Outdoor Receiver OMNIPRO
Rolling Code / Univ. 750mem

Porta de serviço

SE011 - OMNIPRO Sensor Kit for Service Door (Sectional Door) **SE010** and **RX013**



SE010
OMNIPRO wireless sensor
for service door
(Sectional Door)



SE008
Magnet



RX013
OMNIPRO Outdoor Receiver
for service port

Other Service Door Accessories



RX007
Outdoor Receiver OMNIPRO
Rolling Code / Univ. 200mem



SE008
Wireless sensor for service door
(Sectional Door)

1 - Service door sensor
2 - Magnet

Accessories

Photocells



FC001
Photocells (Pair)
Exterior - 20m



FC005
IR BEAM BAT
12m Photocells



FC002
Reflective Photocell - 10m



FC003
Photocell for Glass Door

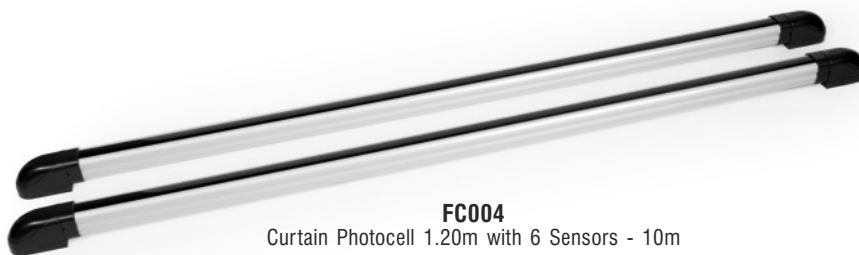

FC004
Curtain Photocell 1.20m with 6 Sensors - 10m



FC006
Curtain Photocell 1, 20m Sequential - 10m



RA001
10MHz Radar - MS-01 Gray



RA002
24MHz Radar - MS-02 Gray



RA003
Radar 24MHz - MS-04 Black



RA004
Dual Radar MSDT Gray Technology



RA005
Dual Vision Infrared Radar



RA006
24MHz Black Radar - 4m



RA007
24MHz Radar i9 Black



RA008
Dual Radar Technology i9 Black

Technical Characteristics

Designation	RA001	RA002 / RA003	RA004	RA005	RA006	RA007	RA008
Color	Gray	Gray / Black	Gray	Black	Black	Black	Black
Technology	Radar	Radar	Radar/Photocell	Radar/Photocell	Radar	Radar	Radar/Photocell
Power supply	12V-30V AC/DC	12V-30V AC/DC	10V-30V AC/DC	12V-30V AC/DC	12V-24V AC/DC	12V-24V AC/DC	12V-24V AC/DC
Frequency	50-60 Hz	50-60 Hz	50-60 Hz	50-60 Hz	50-60 Hz	50-60 Hz	50-60 Hz
Exit sign	Relay	Relay	Relay	Relay	Relay	Relay	Relay
Installation	Máx. 3m	Máx. 3m	Máx. 3m	Máx. 3m	Máx. 4m	Máx. 4m	Máx. 3m
Consumption	166mA	166mA	130mA	160mA	130mA	130mA	160mA
Frequency	10 MHz	24 MHz	24 MHz	24 MHz	24 MHz	24 MHz	24 MHz
Radiation	≤ 20dBm EIRP	≤ 20dBm EIRP	≤ 20dBm EIRP	≤ 20dBm EIRP	≤ 20dBm EIRP	≤ 20dBm EIRP	≤ 20dBm EIRP
Detection mode	Movement	Movement	Movem/Presen.	Movem/Presen.	Movement	Movement	Movem/Presen.
Exit time	0,5s	0,5s	0,5s	0,3s	0,5s	0,5s	0,3s
Room temperature	-20°C to +55°C	-20°C to +55°C	-20°C to +55°C	-20°C to +55°C	-20°C to +55°C	-20°C to +55°C	-20°C to +55°C
IP	52	52	54	54	54	52	52
Dimensions DxHxW	121x80x52mm	121x80x52mm	260x44x53mm	245x66x37mm	120x80x50mm	142x46x45mm	245x68x37mm

**SE003**

Wireless Sensor (Safety Air Bag)
Safety Band

**SE002**

Bi-Channel Magnetic Field Detector
(Double Spiral)

**SE009**

Single Channel Magnetic
Field Detector (One Turn)

Firefly

Lighting module

**PI001**

Firefly LED 230Vac

PI002

Firefly LED 24Vdc

**AC022**

Automatic Ladder

**GS006**

Lighting Module up to
2000W with receiver



CA008
12V Horizontal Electric Lock



CA011
12V Electric
Lock with Button

- 1 - Electric lock
- 2 - Lock fixing plate
- 3 - Swing bolt
- 4 e 5 - Latch fixing plates
- 6 - Screws for fixing
- 7 - Keys

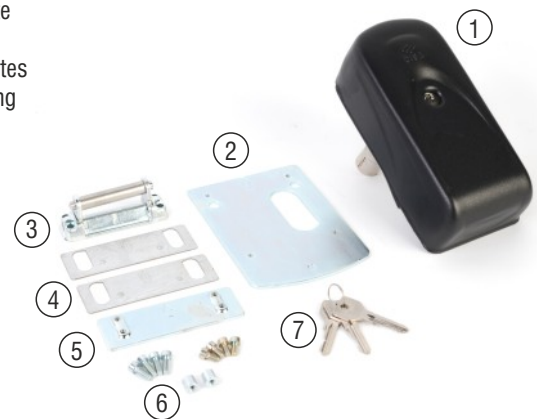

CA012
12V Electric Lock
without Button



CA016
Reversible Electric Lock
for 12V Fire Door

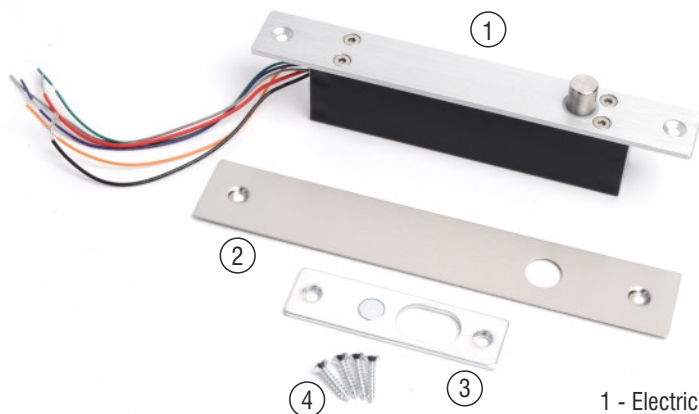

TR004
24V Electric Latch
for Sectional Door

- 1 - Electric latch
- 2 - Mirror
- 3 - Plate with magnet
- 4 - Screws for fixing



B0001
3-Button Pushbutton



B0002
Pushbutton Button Start



B0003
Operating panel
Stop button Emergency



B0004
Operating panel NoTouch



B0005
Wireless Wall Switch
433.92MHz

Key Selector



SC001
Key Selector VG-KS-1



SC003
Dual Key Selector KS-D-04

Safes



SC004
Safe with key opener
with operating panel



SC005
Safe with key for unlocker
with Pushbutton
(Grd.)



AC008
Battery Backup Cables



AC020
Electric Cable 3x1.5



AC021
Electric Cable 4x1,5



AC028
Electric Cable 4x0,75



AC029
Electric Cable 4x0,34

Keys



AC006
Small blank key for molding



AC007
Medium virgin key
for molding (cross)



BT001
12V / 7 Ah Battery



BT003
12V / 1.3 Ah Battery

BT006
Alkaline Battery 27A 12V



BT007
Battery Lithium CR2032



BT005
Alkaline Battery 23A 12V



BT004
Battery Lithium CR2016 3V

Charger | Power supply



CB001
Battery Charger



MP198
Power Supply 12Vdc 3rd

Accessories

Miscellaneous | LCD | Telecrane



PR016
Sheet 16 Pin Male/Female



AC003
Outdoor End of Course



AN001
Outdoor Antenna 433MHz

LCD



GS005
OMNIPRO LCD Graphic
Module

Telecrane



TC001
Transmitter/Receiver Command Kit
for Overhead Cranes and Cranes



Windows Motors



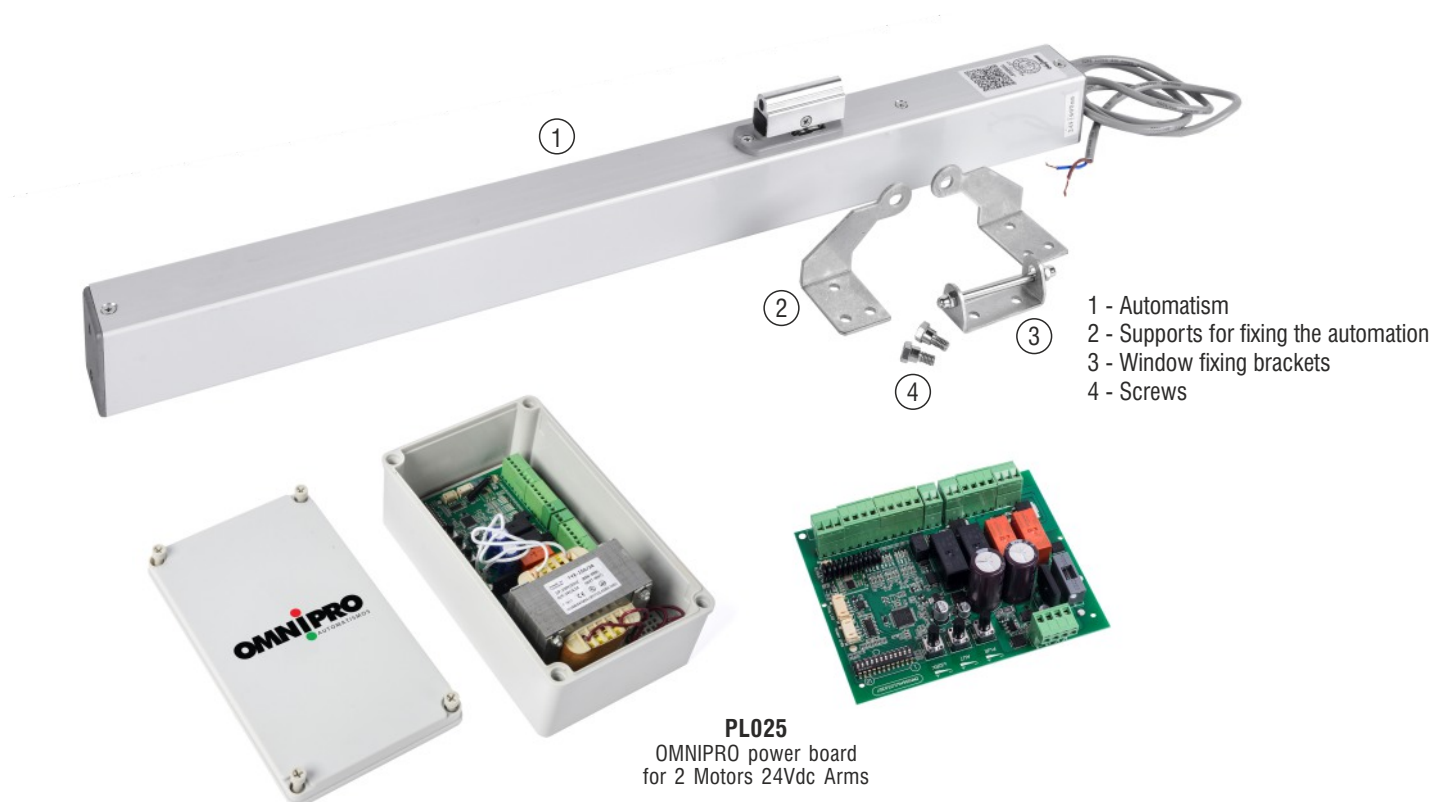

Dimensions

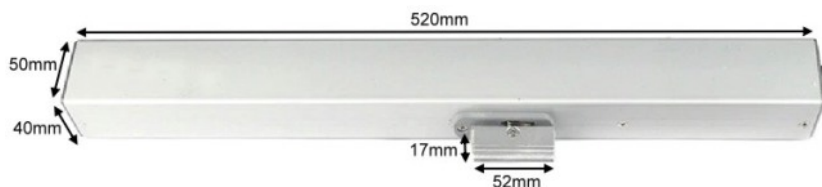

Technical Characteristics

Description	MJ001
Supply Voltage	24Vdc
Force	600N
Maxim. supported weight	60Kg
No-load speed	7mm/s
Aperture range	500mm
Protection index	IP 42
Operating time	4min
Cable length	1m
Weight	2kg
Room temperature	-10°C to +70°C
Standards	EN 55032: 2015 EN 61000-3-2:2014 EN 61000-3-3: 2013

Charact. Tech. of the Control Board

Designation	Control Board (PL025)
Power supply	230Vac - 50Hz
Backup Battery	2 x 12 V for emergency operation in case of power failure (Optional)
Receiver	Rolling Code, 433.92 MHz, 200 Issuers
Temperature	-20°C a +50°C
Electric lock (contact)	12-24 Vac/Vdc 3A maximum current
Protection Index	IP65
Dimensions of the case	H255 x W155 x D100 mm

High Speed Doors



High Speed Doors

RAPYD Motors

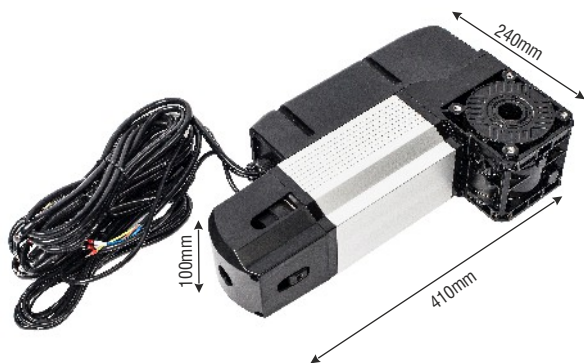

PR001
RAPYD 0.55KW 380Vac
Three-phase with encoder

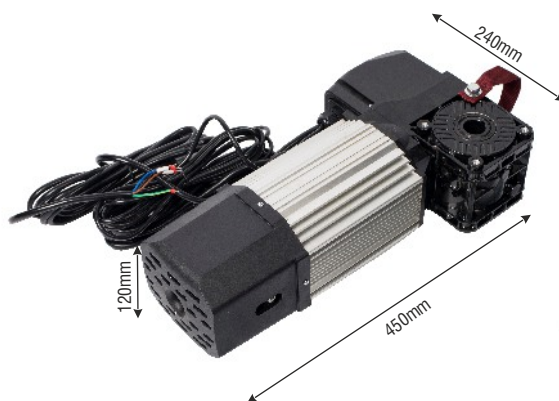

PR002
RAPYD 0.75KW 230V/380Vac
Three-phase/Single-phase
with encoder

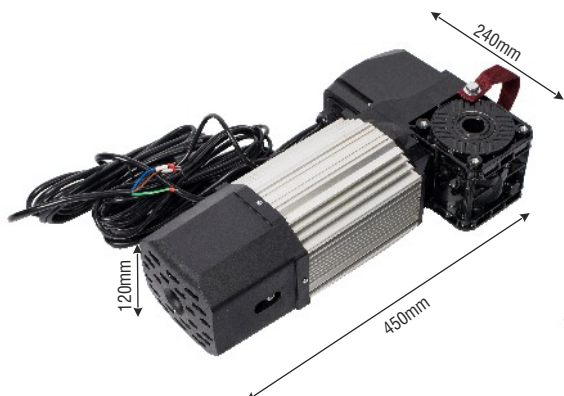

PR003
RAPYD 1,00KW 230V/380Vac
Three-phase/Single-phase
with encoder

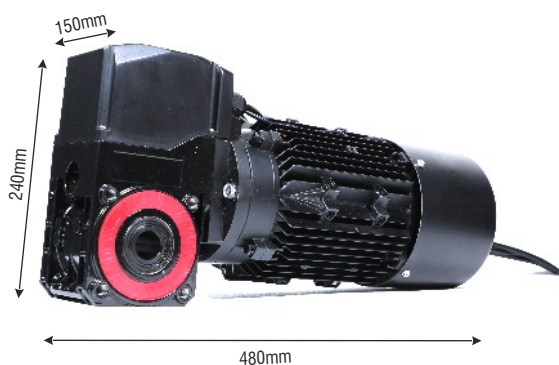

PR004
RAPYD 1,50KW 230V/380Vac
Three-phase/Single-phase
with encoder

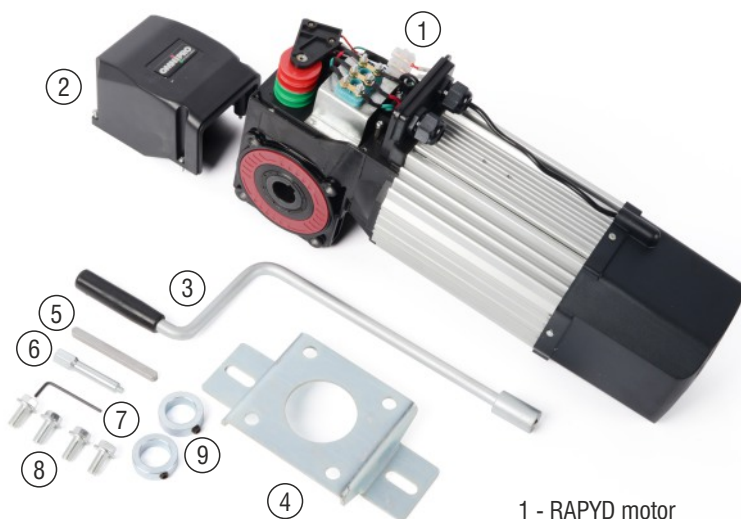

PR015
RAPYD 0.75KW with
Electromechanical limit switch

- 1 - RAPYD motor
- 2 - Cover
- 3 - Crank
- 4 - Engine fixing plate
- 5 - Key
- 6 - Unlocking lever
- 7 - Key to adjust limit switches
- 8 - Engine fixing screws
- 9 - Fixing the key

Technical Characteristics

Motor	PR001	PR002	PR003	PR004	PR015
Power supply	Three-phase				
Speed	0,2 - 0,9 m/s				
Reduction gear	1:43				
Power	0,55KW	0,75KW	1KW	1,5KW	0,75KW
Force	40Nm	60Nm	80Nm	100Nm	60Nm
Door dimension	≤7m²	≤12m²	≤15m²	≤20m²	≤12m²
Room temperature	-20°C to +45°C				
End of course	Encoder				Electromechanical
Board					
Board 380VAC	PL035				
Board 230VAC	X	PL022	PL022		PL022



PL022
230Vac Single Phase Inverter Board



PL035
OMNIPRO power board
for 380Vac Fast Door Motor

Technical Characteristics

Board	PL022 Invert	PL035 Simple
Power supply	230Vac	380Vac
Active power	2KW	2KW
Apparent power	2,4KVA	4,2KVA
Reactive power	1,3KVAR	3,6KVAR
Frequency	10 - 110 Hz	50 Hz
Room temperature	-20°C to +45°C	-20°C to +45°C
Protection	Overloads	Overloads
Box dimensions	H295 x W210 x D115mm	H370 x W240 x D130mm

Security Band Set



SE004
Security Band 36x50 mm Length
adjustable to door dimension



SE001
Wireless Sensor for Security Band
with Interlock



RX003
Conversion Receiver for use
with Security Band



Loading Dock



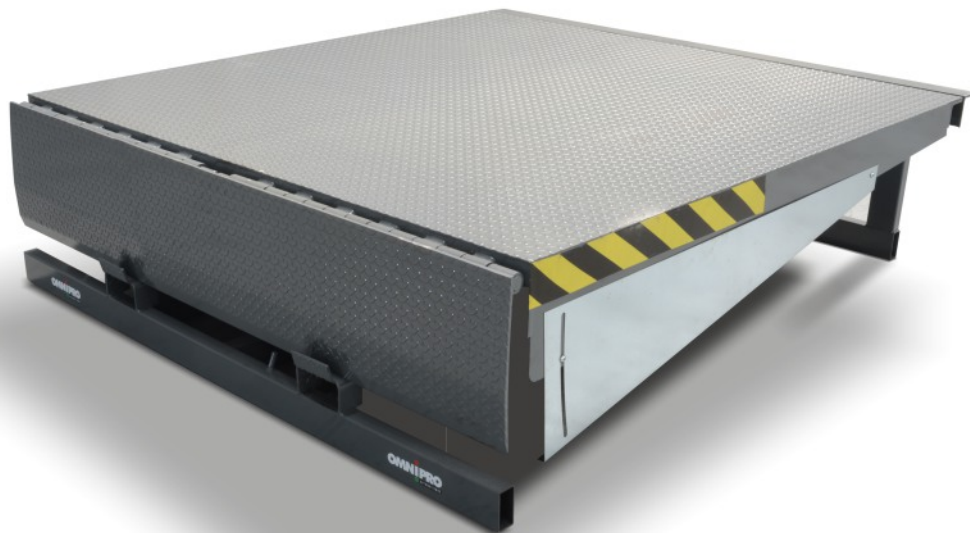

Technical Characteristics







Description	PL034
Supply Voltage	380V, 50Hz
Rated load capacity	6000Kg
Electric motor power	1100W
Output voltage to solenoid valve	24Vac
Maximum pressure of the hydraulic circuit	125 bar
Noise level	<70dB
Maximum working tilt angle	7°
Room temperature	-10°C to +40°C
Structure	Aço Galvanizado
Safety	Anti-shear side protector Cylinders with anti-fall system
Oil	H68 / H46
Finishes	The product structure is made of steel. The coating consists of zinc-iron alloy layers. The minimum galvanized thickness is 25 microns.
Box dimensions	H295 x W210 x D115mm

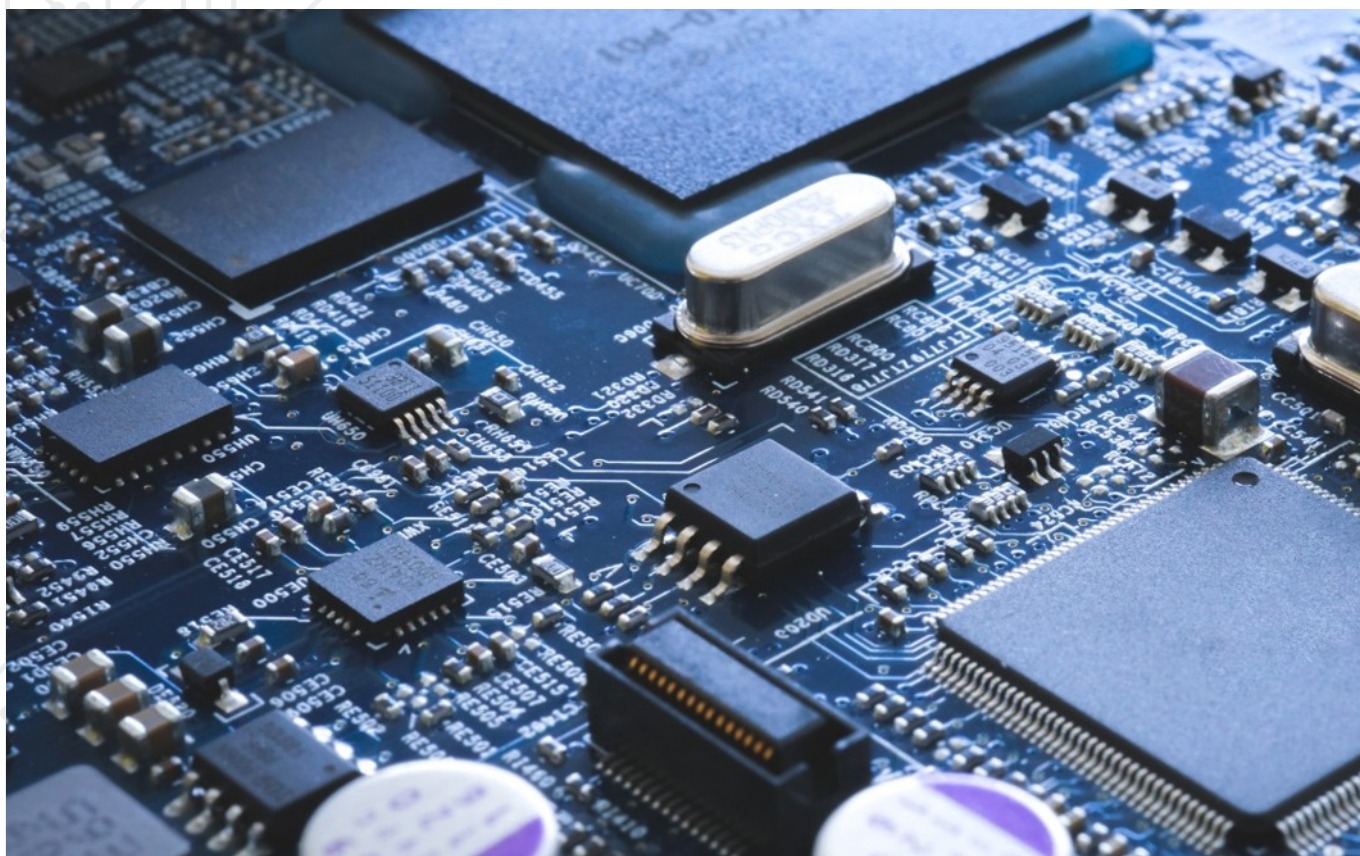

PL034
Table OmniPro to Pier
of load 380Vac









Electronics









Sliding Gates Motors		Swing Gates Motors				Garage Doors Motors
						
PL020	PL024	PL023	PL023FE	PL025	PL025FE	PL032

Board	Primary (230Vac) Secondary(24Vac) Transformer	24Vac		✓			✓	✓	✓
	Power supply	230Vac	✓		✓	✓			
Motor	Power supply	380Vac							
		24Vdc		✓			✓	✓	✓
		230Vac	✓		✓	✓			
Inputs		380Vac							
		Operating panel Pedestrian	✓	✓	✓	✓	✓	✓	
		Step-by-step push button	✓	✓	✓	✓	✓	✓	✓
		Operating panel Opening	✓	✓	✓	✓	✓	✓	
		Operating panel Closing	✓	✓	✓	✓	✓	✓	
		Operating panel Stop	✓	✓	✓	✓	✓	✓	
		Emergency push button							
		Radars							
		Service port							✓
		End of course	✓	✓	✓	✓	✓	✓	
		Encoder		✓					✓
		Emergency Battery		24Vdc			24Vdc	24Vdc	24Vdc
		GSM modem	✓	✓	✓	✓	✓	✓	

Technical Characteristics











MPRO		Rolling Grilles	Basenjoy i9	Pedestrian Door	Barriers	Bollards	RAPYD		Loading Dock
									
PL029	PL028	PL021	PV014	MB043	PL030	PL027	PL022	PL035	PL034

			✓	✓					
✓		✓			✓	✓	✓		
	✓							✓	✓
			✓	✓					
✓		✓			✓	✓	✓		
	✓							✓	✓
✓	✓	✓			✓	✓	✓	✓	✓
✓	✓	✓	✓	✓	✓	✓	✓	✓	✓
✓	✓	✓		✓	✓	✓	✓	✓	✓
✓	✓	✓			✓	✓	✓	✓	✓
✓	✓					✓	✓	✓	✓
			✓	✓			✓	✓	
✓	✓								
✓	✓	✓			✓	✓	✓	✓	
✓	✓		✓	✓			✓	✓	
			24Vdc	24Vdc		12Vdc			
✓	✓	✓			✓	✓		✓	✓

Sliding Gates Motors		Swing Gates Motors				Garage Doors Motors
						
PL020	PL024	PL023	PL023FE	PL025	PL025FE	PL032

Outputs	Firefly	230Vac	24Vdc	230Vac	230Vac	24Vdc	24Vdc	24Vdc
	Contact Electric Lock	24Vdc max. 3A	24Vdc max. 3A	24Vdc max. 3A	24Vdc max. 3A	24Vdc max. 3A	24Vdc max. 3A	
	Power supply Electric lock				12Vdc max. 3A		12Vdc max. 3A	
	Accessories supply	12Vdc 0,5A	12Vdc 0,5A	12Vdc 0,5A	12Vdc 0,5A	12Vdc 0,5A	12Vdc 0,5A	12Vdc 0,5A
	LCD (GS005)	✓	✓	✓	✓	✓	✓	
Issuers	Step by step	✓	✓	✓	✓	✓	✓	
	Pedestrian opening	✓	✓	✓	✓	✓	✓	
	Memory Capacity	200 un.	200 un.	200 un.	200 un.	200 un.	200 un.	20 un.
Security	Crush Detection		✓			✓	✓	✓
	Photocells	✓	✓	✓	✓	✓	✓	✓
	Security Band	✓	✓	✓	✓	✓	✓	
Inputs	Man present at the clasp							
	Man Present Open ./ Closing							
	Force Regulation	✓	✓	✓	✓	✓	✓	✓
	Speed regulation							
	Sensitivity Regulation		✓			✓	✓	✓
	Opening/Closing slowdown	✓	✓	✓	✓	✓	✓	✓
	Adjust. Strength Deceleration	✓		✓	✓			
	Reg.Auto Closing(up to 2min.)	✓	✓	✓	✓	✓	✓	✓
	Change Motor Rotat. Direction	✓	✓	✓	✓	✓	✓	
	Condominium Mode	✓	✓					✓
	Record Working Time	✓	✓	✓	✓	✓	✓	✓
	Advance Notice	✓	✓	✓	✓	✓	✓	
	Interconnection between ports							
	Disable Outdoor Radar							

Technical Characteristics (Continued)

MPRO		Rolling Grilles	Basenji i9	Pedestrian Door	Barriers	Bollards	RAPYD		Loading Dock
									
PL029	PL028	PL021	PV014	MB043	PL030	PL027	PL022	PL035	PL034

230Vac	230Vac	230Vac			230Vac	230Vac	230Vac	230Vac	230Vac
24Vdc max. 3A	24Vdc max. 3A	24Vdc max. 3A	24Vdc 0,2A	12Vdc max. 0,5A					
24Vdc 1A	24Vdc 1A	12Vdc 0,5A	24Vdc 0,3A	24Vdc 0,3A	12Vdc 0,5A	12Vdc 0,5A	24Vdc 1A	24Vdc 1A	24Vdc 1A
✓	✓	✓			✓	✓		✓	✓
✓	✓	✓			✓	✓			
200 un.	200 un.	200 un.			200 un.	200 un.			
			✓	✓					
✓	✓	✓	✓	✓	✓	✓	✓	✓	✓
✓	✓	✓			✓		✓	✓	
✓	✓	✓					✓	✓	
									✓
			✓	✓			✓		
			✓	✓			✓		
			✓	✓					
			✓	✓			✓		
✓	✓	✓		✓	✓	✓	✓	✓	
✓	✓	✓	✓	✓	✓	✓	✓	✓	✓
				✓					
							✓	✓	
✓	✓	✓			✓	✓	✓	✓	✓
✓	✓		✓	✓			✓	✓	
			✓	✓					

OMNIPRO power board for 230V AC Running Motor

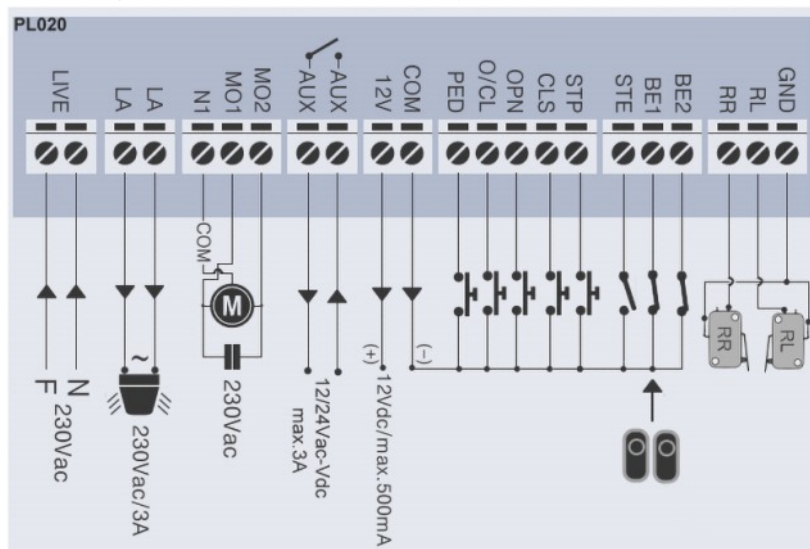

OMNIPRO power board for 24V DC Running Motor

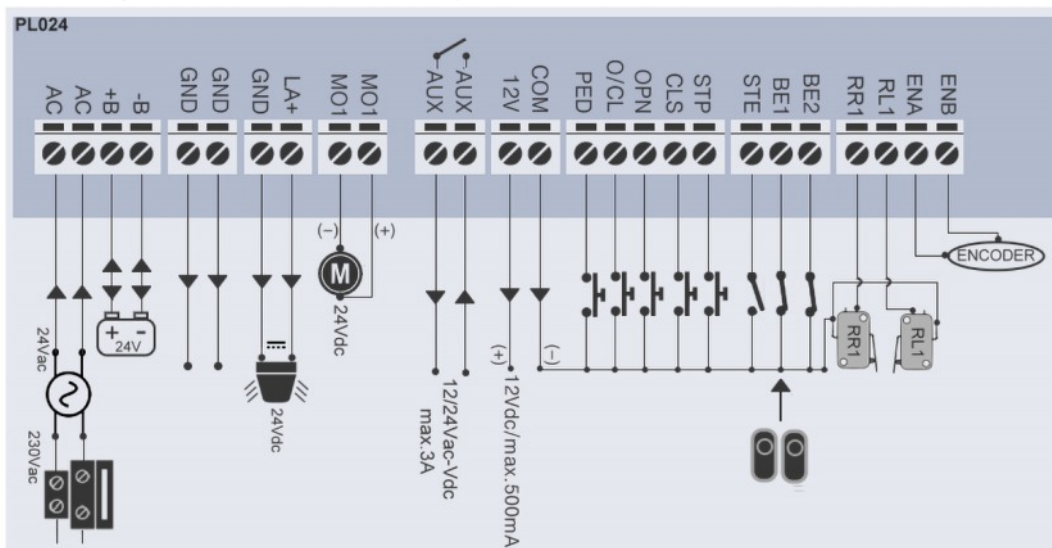

OMNIPRO power board for 2 Arm 230V AC Motors

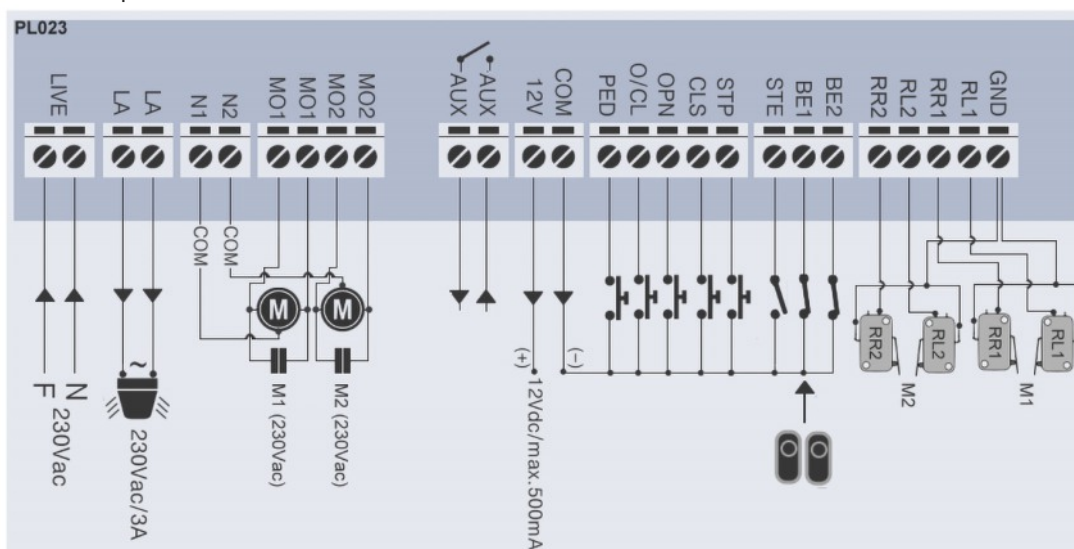

Electrical Schemes PL023FE | PL025 | PL025FE

OMNIPRO power board for 2 Motor Arms 230V AC (Electric Lock)

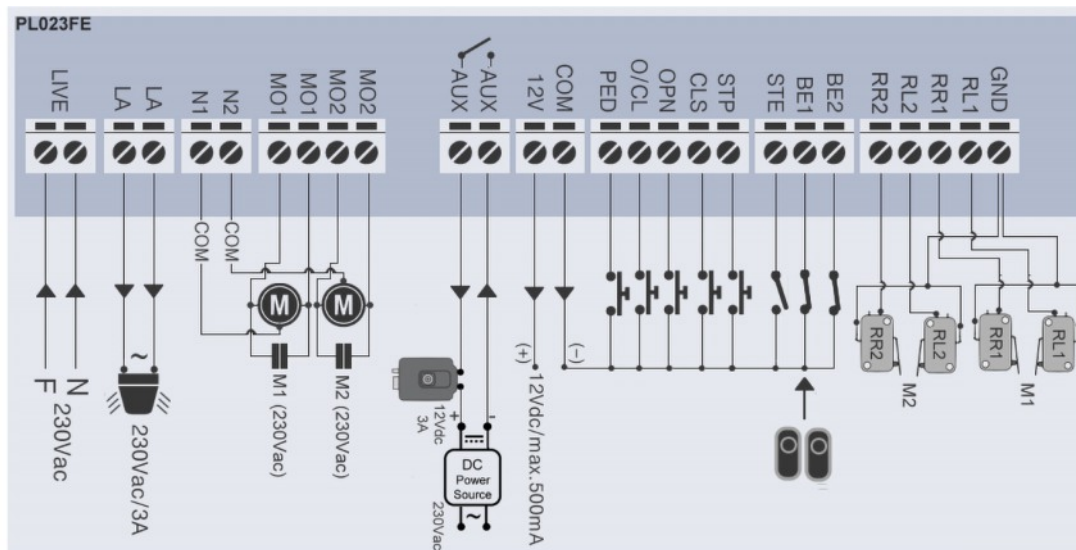

OMNIPRO power board for 2 Arm 24V DC Motors

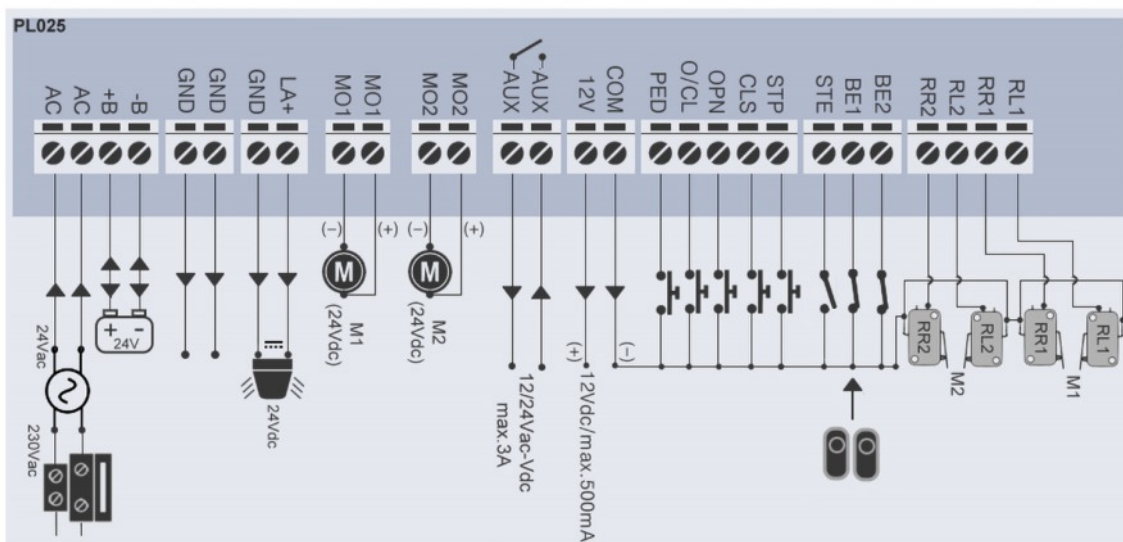

OMNIPRO power board for 2 Arm 24V DC Motors (Electric Lock)

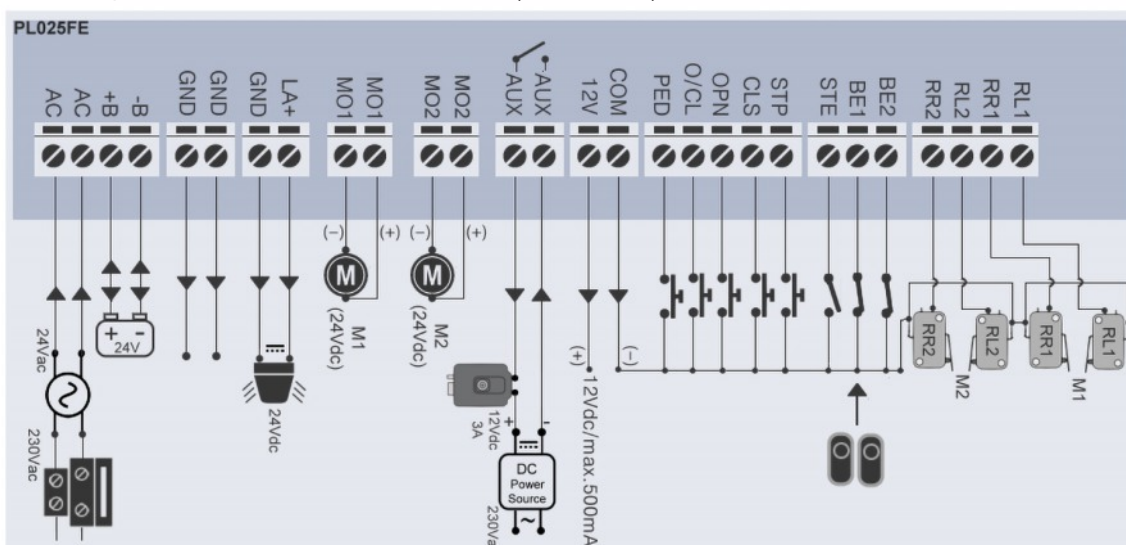

Electrical Schemes PL021 | PV014 | MB043

OMNIPRO power board for 230V AC Windina Grid Motor

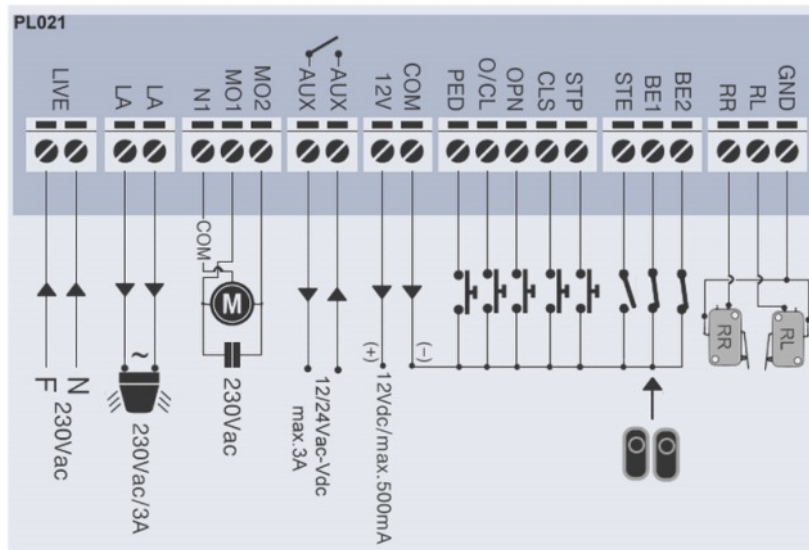

BASENJY i9 Glass Door Control Plate

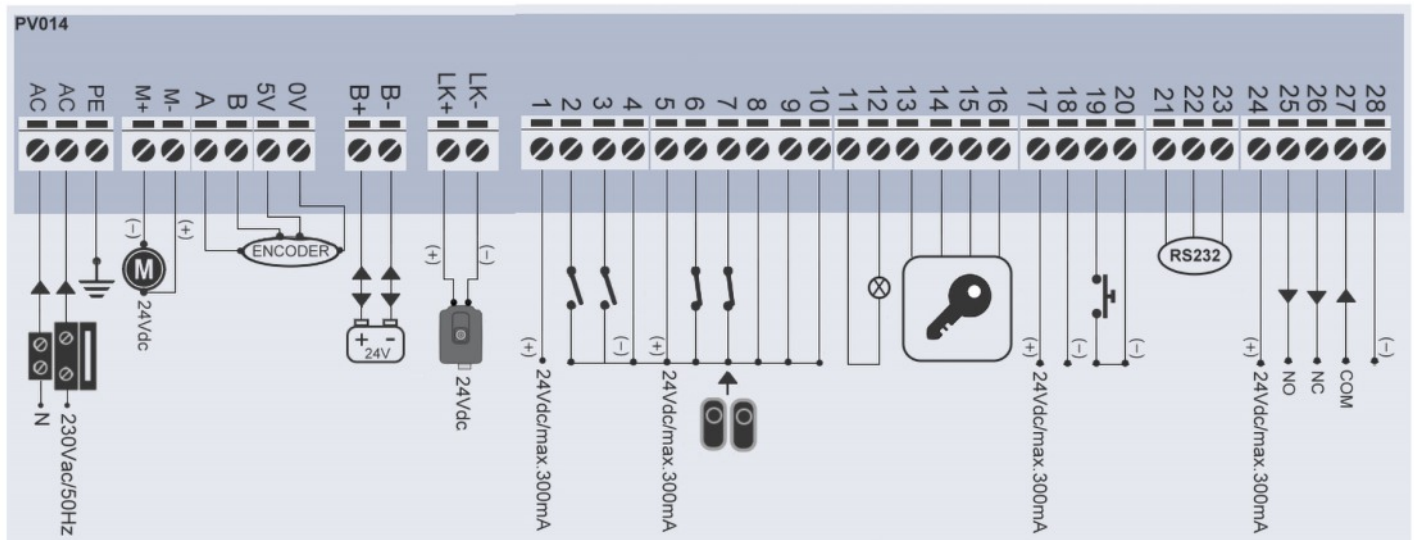

Multifunction Pedestrian Board

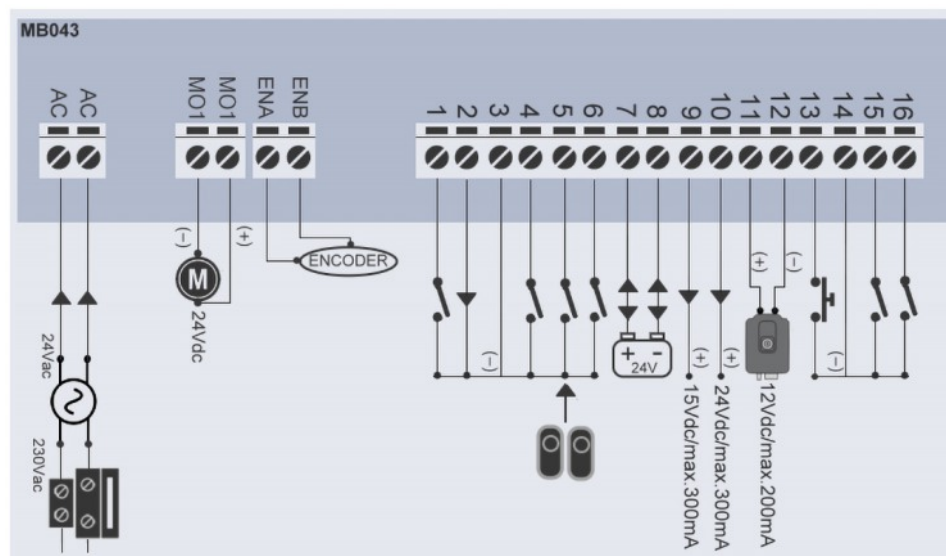

PL030

The diagram shows the PL030 terminal block with the following connections:

- GND**: Connected to the ground terminal.
- RL**: Connected to the RL terminal.
- RR**: Connected to the RR terminal.
- BE2**: Connected to the BE2 terminal.
- BE1**: Connected to the BE1 terminal.
- STE**: Connected to the STE terminal.
- STP**: Connected to the STP terminal.
- CLS**: Connected to the CLS terminal.
- OPN**: Connected to the OPN terminal.
- O/CL**: Connected to the O/CL terminal.
- PED**: Connected to the PED terminal.
- COM**: Connected to the COM terminal.
- 12V**: Connected to the 12V terminal.
- AUX**: Connected to the AUX terminal.
- MO2**: Connected to the MO2 terminal.
- MO1**: Connected to the MO1 terminal.
- N1**: Connected to the N1 terminal.
- LA**: Connected to the LA terminal.
- LIVE**: Connected to the LIVE terminal.

Additional components and connections shown:

- A motor (M) is connected to the COM and 12V terminals.
- A fan (F) is connected to the LA and LIVE terminals.
- The motor is rated for 230Vac.
- The fan is rated for 230Vac/3A.

PL027

The diagram illustrates the wiring for the PL027 lighting fixture. It shows the connection of various inputs to the fixture's internal components. The inputs are labeled as follows: GND, RL1, RL2, RR1, RR2, BE2, BE1, STE, STP, CLS, OPN, O/CL, PED, COM, 12V, AUX, and AUX. The fixture contains two relays (RL1, RL2), two relays (RR1, RR2), two relays (BE1, BE2), two relays (STE, STP), two relays (CLS, OPN), two relays (O/CL, PED), two relays (COM, 12V), and two relays (AUX, AUX). The fixture is powered by a 230V ac/3A source. The output is labeled N 230Vac and F 230Vac.

PL022

The diagram shows the PL022 module with the following connections:

- Power and Motor:** BL, BN, W, U, V, PE, N, L are connected to a 230Vac/3A motor. BL and BN are connected to the motor's main terminals. W, U, and V are connected to the motor's speed control terminals. PE, N, and L are connected to the power supply.
- Encoder:** GND, A, B, and Vcc are connected to an ENCODER.
- Control and Status:** OH, COM, STOP, CLOSE, OPEN, KEY, EX, COM, 24V, COM, INF, COM, RAD, LKI, LKO, COM, OP, CL, COM1, F1, and F2 are connected to various control and status components, including a 24Vdc/max. 1A power source, a switch, and a PVC unit.

Electrical Schemes PL035 | PL034

OMNIPRO power board for 380V AC Fast Door Motor

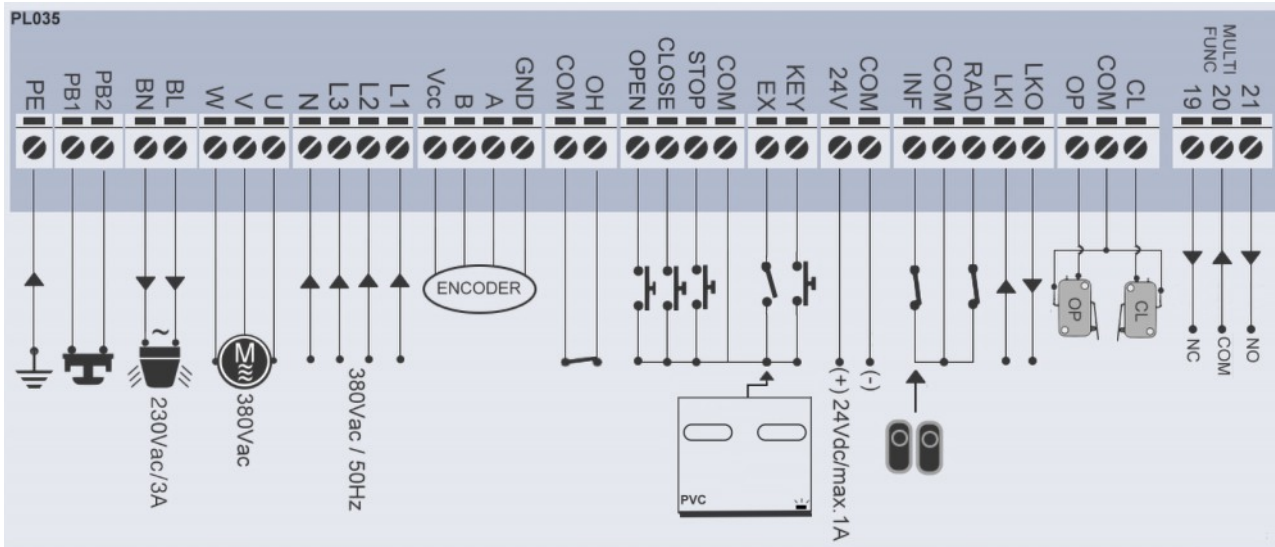

OMNIPRO power board for 380V AC Charging Pier

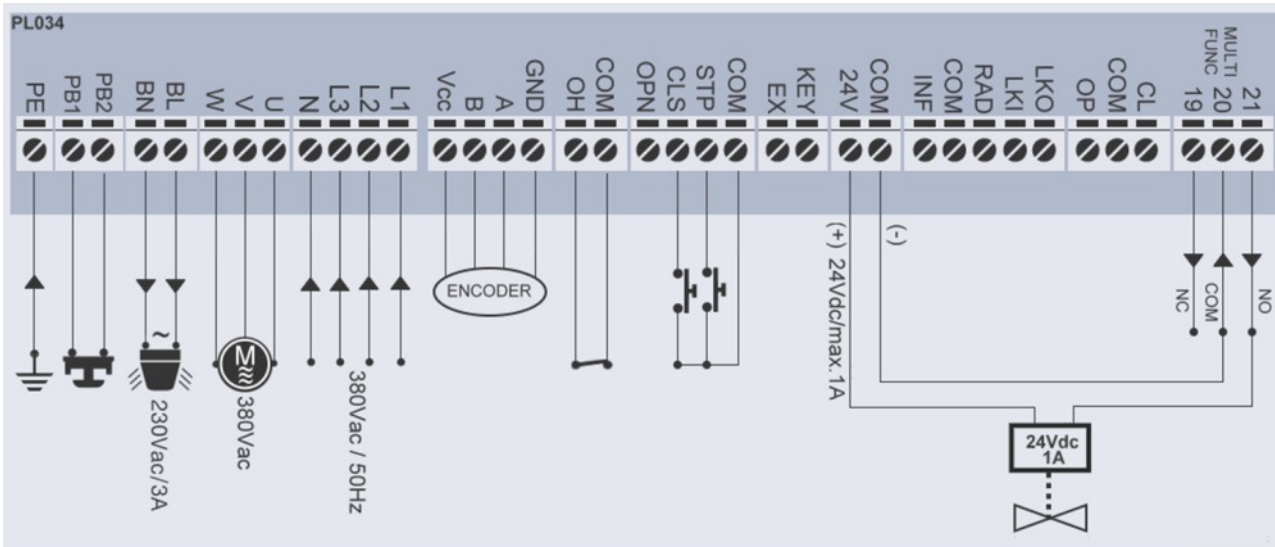

Support service



OMNIPRO provides support services to the installation and putting into operation of your equipment, through a dedicated customer support line (applied to business days from 8:30 am to 6:30 pm) +351 220 136 648.

OMNIPRO considers that the support must comply with a critical service level, with a maximum response time of 8h and parts repair time of 72h upon entry into our facilities.

General conditions



TECHNICAL DOCUMENTATION

- **OMNIPRO** provides the necessary technical documentation for the exploration of the proposed equipment

WARRANTY

- The proposed equipment is guaranteed for 2 (two) years against any manufacturing defects except the roof motor which is guaranteed for 3 (three) years.

SUPPLY CONDITIONS

- The prices mentioned will be increased by the current VAT rate, and should be considered for equipment to be loaded in our warehouses.

PAYMENT CONDITIONS

- Payment terms to be negotiated.

PRODUCT CHARACTERISTICS

- The characteristics of the products described in the respective catalogs may be subject to change without prior notice, OMNIPRO reserving the right to introduce modifications in form, dimension and composition or techniques or even suppress the production/marketing of any product.

PRICES

- The values contained in the price lists can be changed at any time without prior notice, and are always subject to application. VAT at the legal rate in force.

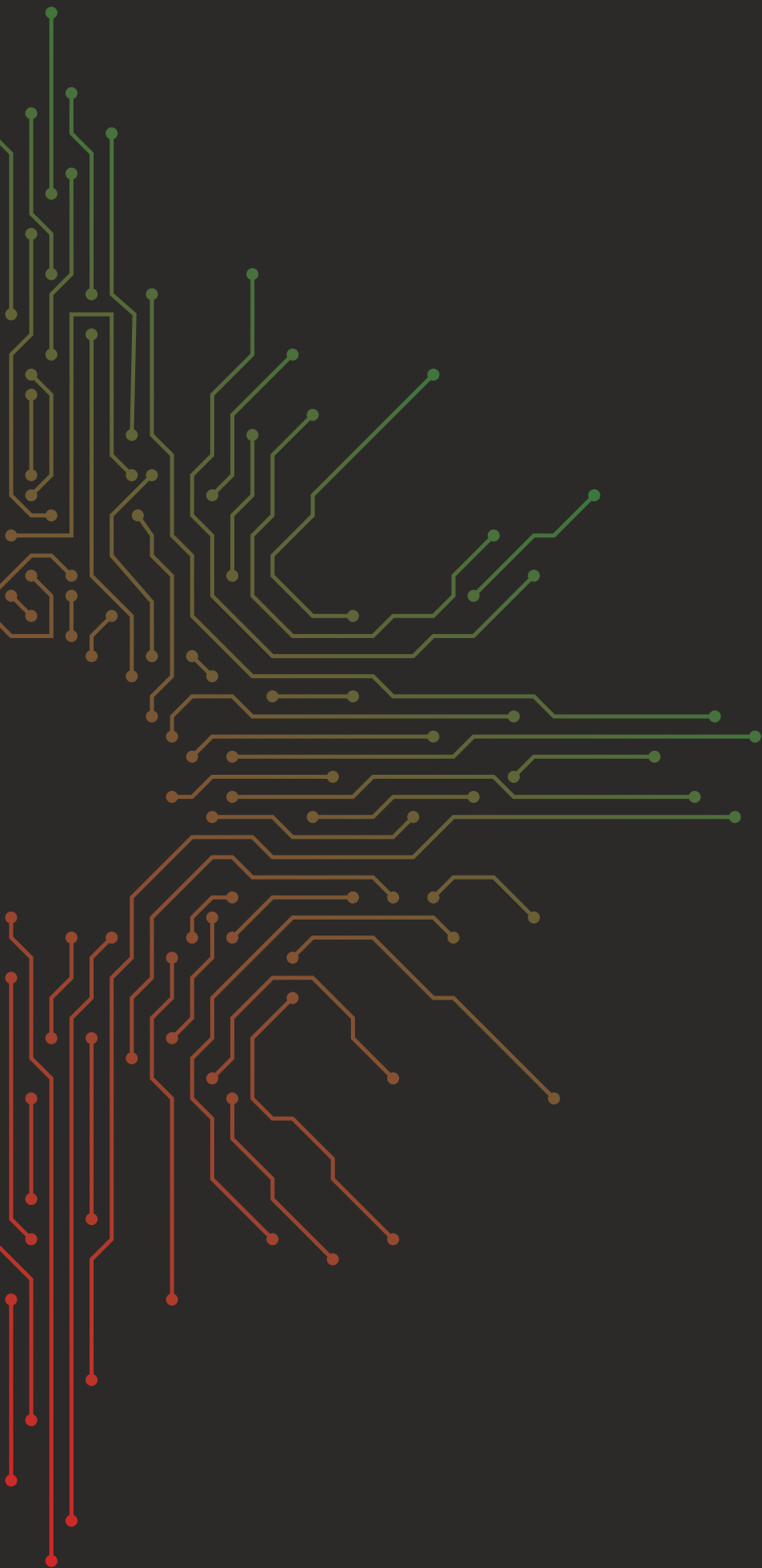

OMNIPRO
AUTOMATISMOS



 Rua Nicolau Ennor 38
4440-239 CAMPO
Valongo | PORTUGAL

 geral@omnipro.pt

 tecnico@omnipro.pt
dep.tecnico@omnipro.pt

 +351 220 136 168

 +351 220 136 648

 www.omnipro.pt

 omniprolda

Distributed by: